

Architectural Art Mfg.

A division of Pittcon Architectural Metals, LLC

TECH DATA SHEET

B Series

Interior Expansion Joint Cover System

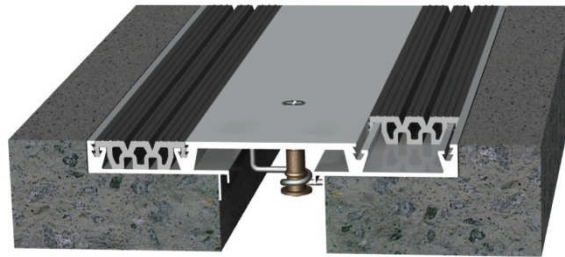

B20-16-11 Illustrated

DESCRIPTION:

The B Series is a Dual elastomeric system designed for floor and wall expansion joint applications. It is a combination aluminum alloy and elastomeric seal product allowing plus and minus 25-50% thermal movement and up to 100% seismic movement in nominal expansion joint gaps of 1" to 12".

OPTIONS:

Floor to Floor, Floor to Wall, Cast-in-place, New to Existing, Recessed, Aluminum, Bronze, and Stainless Steel, with smooth santoprene or v-groove vinyl elastomeric seals in multiple colors.

TYPICAL APPLICATIONS:

Interior floor expansion joint applications for use in various construction projects including: Health-Care, Transportation, Recreation, Retail, Commercial and Educational. Recommended for Pedestrian Loading only

PACKAGING:

- Expansion joint aluminum components are shipped in standard 10 foot lengths.
- Elastomeric seal is boxed and shipped in continuous lengths.
- All materials and components are palletized and/or packaged in manufacturer's standard packaging.
- Aluminum profiles supplied in standard mill finish. Exposed wall profiles supplied in standard Clear Anodize finish.

PHYSICAL PROPERTIES:

Aluminum Extrusions & Plates: Conform to ASTM B221, for alloys 6063-T6 or 6061-T6.

Aluminum Sheet: Conforms to ASTM B221, for alloys 5052-H32 or 3003-H14.

Elastomeric Seal: Conforms to ASTM C920 flexible extruded polyvinylchloride or ASTM D412 Santoprene 591-65A, 691-65A Thermoplastic Rubber in standard colors

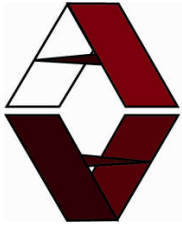

Architectural Art Mfg.

A division of Pittcon Architectural Metals, LLC

B SERIES - DESIGN OPTIONS

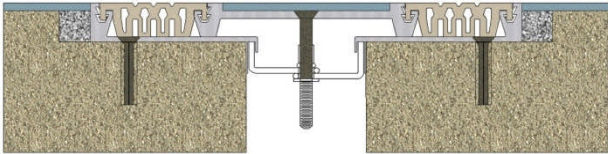

FLOOR TO FLOOR

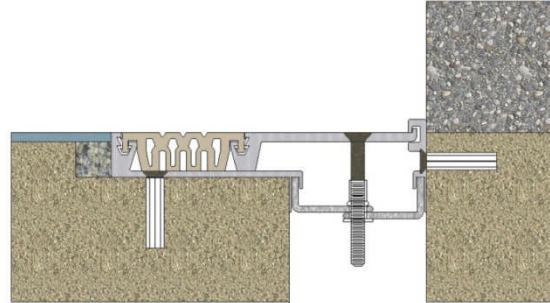

FLOOR TO WALL



FLOOR TO FLOOR WIDE

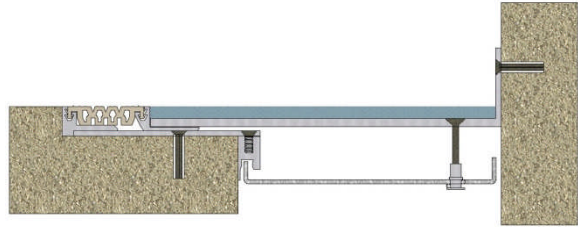

FLOOR TO WALL WIDE

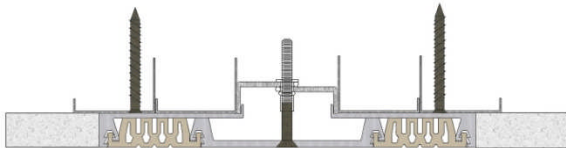

WALL TO WALL

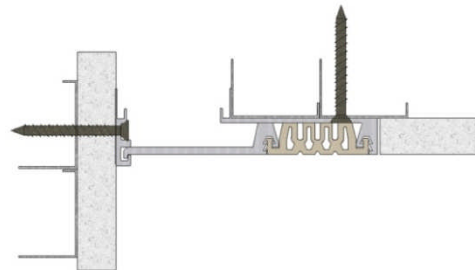

CORNER WALL

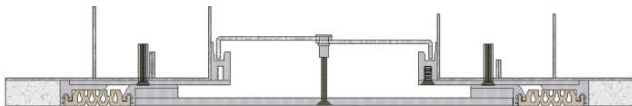

FLOOR TO FLOOR WIDE

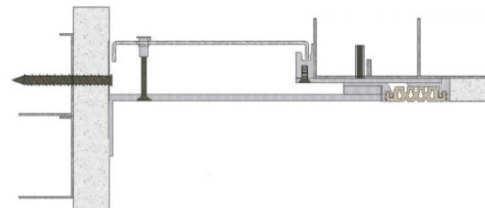

CORNER WALL WIDE

6409 Rhode Island Avenue, Riverdale, Maryland 20737-1098

Phone (301) 927-1000 Fax (800) 897-3129

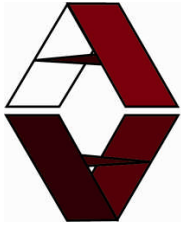

Architectural Art Mfg.

A division of Pittcon Architectural Metals, LLC

B SERIES - DESIGN DESIGNATIONS

DESIGNATION	DESCRIPTION	JOINT SIZES		MOVEMENT *
		inches	mm	
B-16	FLOOR TO FLOOR - FLUSH MILL FIN. ALUM. COVER	1" - 12"	25 - 300	25% - 100%
B-13	FLOOR TO FLOOR - ABRASIVE FIN. ALUM. COVER	1" - 12"	25 - 300	25% - 100%
B-17	FLOOR TO FLOOR - 1/8" RECESS ALUM. COVER	1" - 12"	25 - 300	25% - 100%
B-18	FLOOR TO FLOOR - 3/8" RECESS ALUM. COVER	1" - 12"	25 - 300	25% - 100%
B-36	FLOOR TO WALL - FLUSH MILL FIN. ALUM. COVER	1" - 12"	25 - 300	25% - 100%
B-33	FLOOR TO WALL - ABRASIVE FIN. ALUM. COVER	1" - 12"	25 - 300	25% - 100%
B-37	FLOOR TO WALL - 1/8" RECESS ALUM. COVER	1" - 12"	25 - 300	25% - 100%
B-51	WALL TO WALL - CLEAR ANODIZED ALUM. COVER	1" - 12"	25 - 300	25% - 100%
B-61	CORNER WALL - CLEAR ANODIZED ALUM. COVER	1" - 12"	25 - 300	25% - 100%

* Note: For individual movement capability, see actual detail.

www.archart.com

Available Colors of Vinyl and Santoprene®



Black



Brown



Beige



Gray



White

Note: all colors shown above are photographic representations only. Since the color lithography reproduction process can only approximate product color values for reference purposes, it is suggested actual samples be obtained from the manufacturer for true and accurate color selection.

Limited Warranty

Architectural Art Mfg., a division of Pittcon Architectural Metals, LLC, warrants to its purchaser that all its products will be free of material or manufacturing defects for one (1) year. Any claim brought to the attention of Architectural Art Mfg., a division of Pittcon Architectural Metals, LLC, by the customer in writing; within one year of substantial completion will be examined.

If the product has failed under the terms of the warranty, it will be replaced or repaired free of charge. Architectural Art Mfg., a division of Pittcon Architectural Metals, LLC, will not be responsible for installation costs involved in such replacement or repair, consequential or other damages of any nature. This is in lieu of all other warranties expressed or implied and is the sole warranty extended.

The right is hereby reserved to make changes from time to time in styles and construction whenever deemed advisable and to withdraw from sales any item whenever necessary. In presenting these products Architectural Art Mfg., a division of Pittcon Architectural Metals, LLC, cannot claim to serve in any but an advisory capacity and can undertake no liability. The use of our products should be modified, if necessary, to conform to local conditions and materials employed.

6409 Rhode Island Avenue, Riverdale, Maryland 20737-1098

Phone (301) 927-1000 Fax (800) 897-3129