

W20-CS-SI

FORMERLY W20-51-81

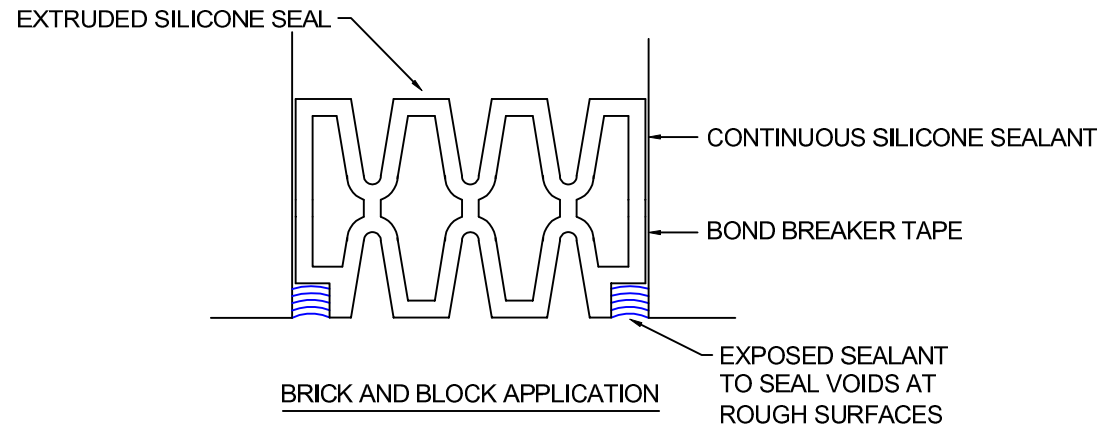
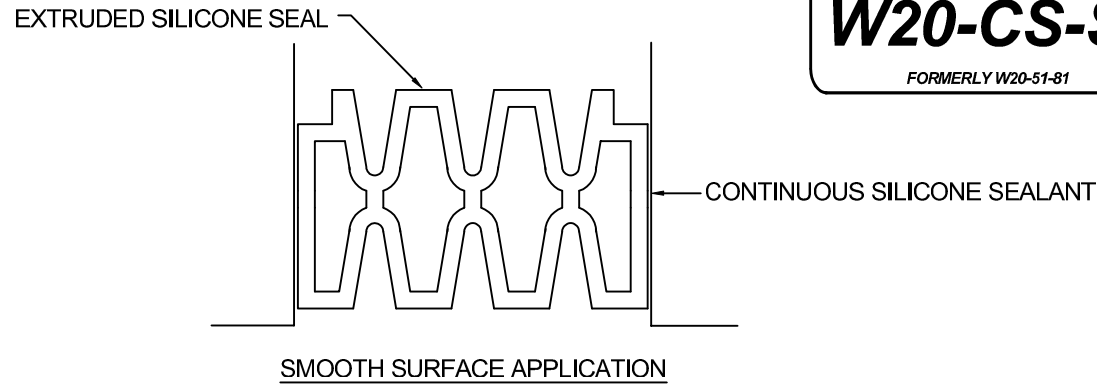

COMPRESSION SEALS - SILICONE SEISMIC JOINT SEALS
SECURE WITH HIGH - QUALITY COMPATIBLE SEALANT / ADHESIVE
MEETS ASTM D2000, 4GE, 709M
UV STABILIZED
DOES NOT PROPAGATE FLAME
EXTRUDED SIZE: 2.5" x 1"
NOMINAL JOINT WIDTH: 2"
MIN. COMPRESSION: 1"
MAX. EXTENSION: 3.5"
COLOR AS SELECTED BY ARCHITECT

CUSTOMER:			MARK:	QTY:	LENGTH:	LOCATION:
PROJECT:						
LOCATION:						
ARCHITECT:						
CONTRACTOR:						
NOTE:						
JOB NO.:	DATE:	SCALE: (NTS)				

ARCHITECTURAL ART MFG.

6409 RHODE ISLAND AVE. RIVERDALE, MD 20737 PHONE (800) 835-0028 FAX (316) 462-0511 WWW.ARCHART.COM

AAM RESERVES THE RIGHT TO MAKE DESIGN CHANGES, OR TO WITHDRAW ANY DESIGN WITHOUT NOTICE

© COPYRIGHT 2007 AAM