

COLOR SELECTION:

BLACK, LIMESTONE, DUSTY  
 ROSE, BRONZE, PRECAST WHITE,  
 RUSTIC BRICK, SANDSTONE, NATURAL  
 STONE, BLUE SPRUCE, ADOBE TAN,  
 GRAY, CHARCOAL

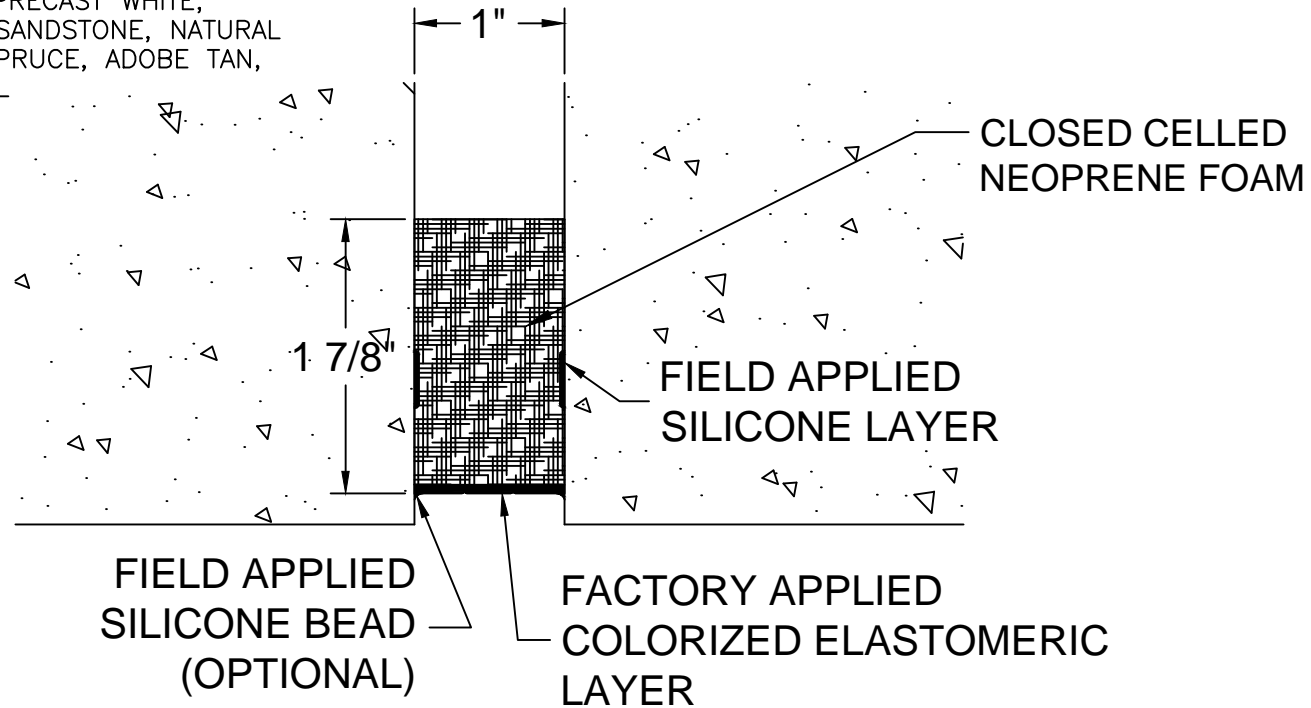

DESCRIPTION: WALL TO WALL (EXTERIOR)  
 EXPOSED FINISH: SILICONE  
 MOVEMENT: PLUS OR MINUS 25% JOINT WIDTH  
 STOCK LENGTHS: 5'-0"

**W10-SF-SI**  
 Formerly W10-56-81



**Architectural Art**  
 MANUFACTURING

Division of Pittcon Architectural Metals, LLC  
 283 SWANSON DRIVE, STE 103  
 LAWRENCEVILLE, GA 30043  
 PH: (678) 680-7373 FAX: (678) 735-0085  
 TOLL FREE: (800) 835-0028 web: www.archart.com

**EXTERIOR VERTICAL WALL SYSTEM**

MODEL: W10-SF-SI

DRAWN BY:  
 NDC

SCALE:  
 NTS

DRAWING NO.:

SHT. 1 OF 1

ISSUE DATE:  
 06/01/09

**DTL-01**

NO.	DESCRIPTION	BY	DATE

REVISIONS

The information contained herein is the proprietary property of **ARCHITECTURAL ART MFG.**, Division of Pittcon Architectural Metals, LLC. No portion of it may be reproduced by any means or used in any form except for the purpose for which it was furnished. All rights of design and invention are hereby reserved. We reserve the right to make changes in the design at our discretion.