

# R50-64-94

REV. 7/06

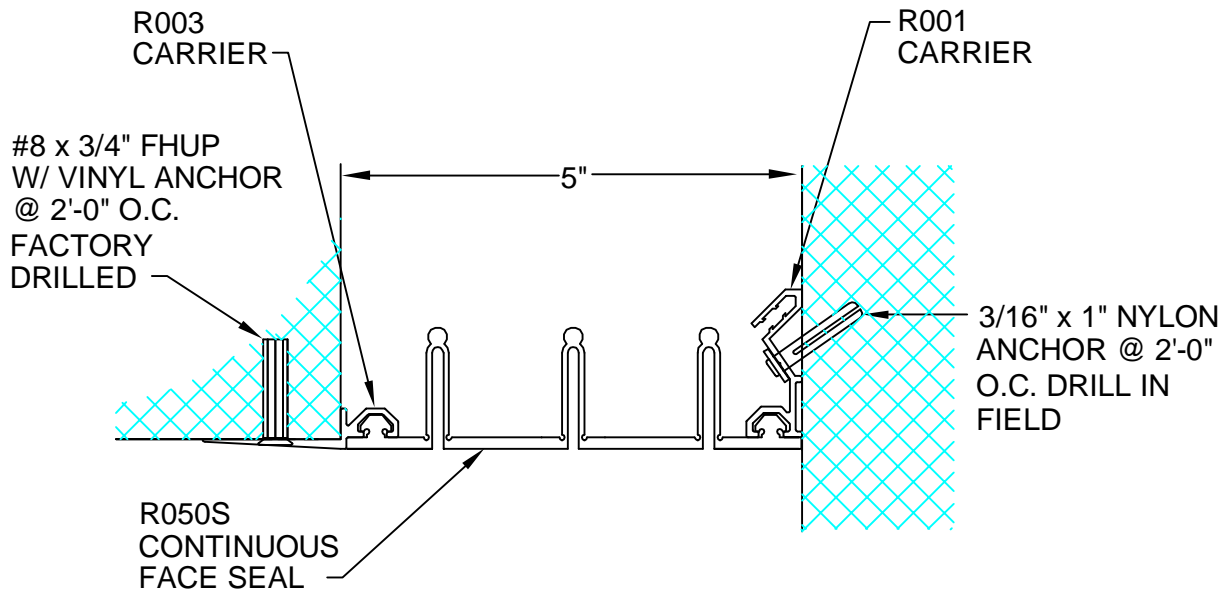

DESCRIPTION: INTERIOR CORNER WALL/CEILING  
 ALUMINUM: 6063-T5 EXTRUSION  
 FACE SEAL: SANTOPRENE  
 EXPOSED FINISH: R1-204 CLEAR ANODIZED  
 W/ STRIPPABLE PROTECTIVE TAPE  
 ALLOWABLE LOAD: -NOT DESIGNED FOR STRUCTURAL LOADS-  
 MOVEMENT: + 100% TENSION/COMPRESSION TO 1 1/4"  
 STOCK LENGTHS: 20'-0" (ALUMINUM)

CUSTOMER:		
PROJECT:		
LOCATION:		
ARCHITECT:		
CONTRACTOR:		
NOTE:		
JOB NO.:	DATE:	SCALE: (NTS)

LENGTH:	QTY:	COLOR/FINISH: