

R50-54-94

REV. 7/06

#8 x 3/4" FHUP
W/ VINYL ANCHOR
@ 2'-0" O.C.
FACTORY DRILLED

R003
CARRIER

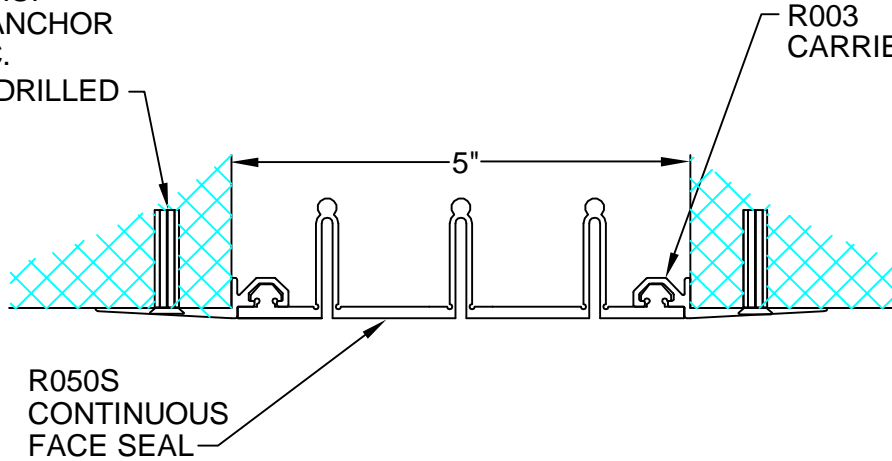

R050S
CONTINUOUS
FACE SEAL

DESCRIPTION: INTERIOR FLAT WALL/CEILING
ALUMINUM: 6063-T5 EXTRUSION
FACE SEAL: SANTOPRENE
EXPOSED FINISH: R1-204 CLEAR ANODIZED
W/ STRIPPABLE PROTECTIVE TAPE
ALLOWABLE LOAD: -NOT DESIGNED FOR STRUCTURAL LOADS-
MOVEMENT: + 100% TENSION/COMPRESSION TO 1 1/4"
STOCK LENGTHS: 20'-0" (ALUMINUM)

CUSTOMER:		
PROJECT:		
LOCATION:		
ARCHITECT:		
CONTRACTOR:		
NOTE:		
JOB NO.:	DATE:	SCALE: (NTS)

LENGTH:	QTY:	COLOR/FINISH: