

DESIGNED TO BE USED WITH  
AN EXPANSION JOINT COVER  
TO CREATE A FIRE RATED ASSEMBLY

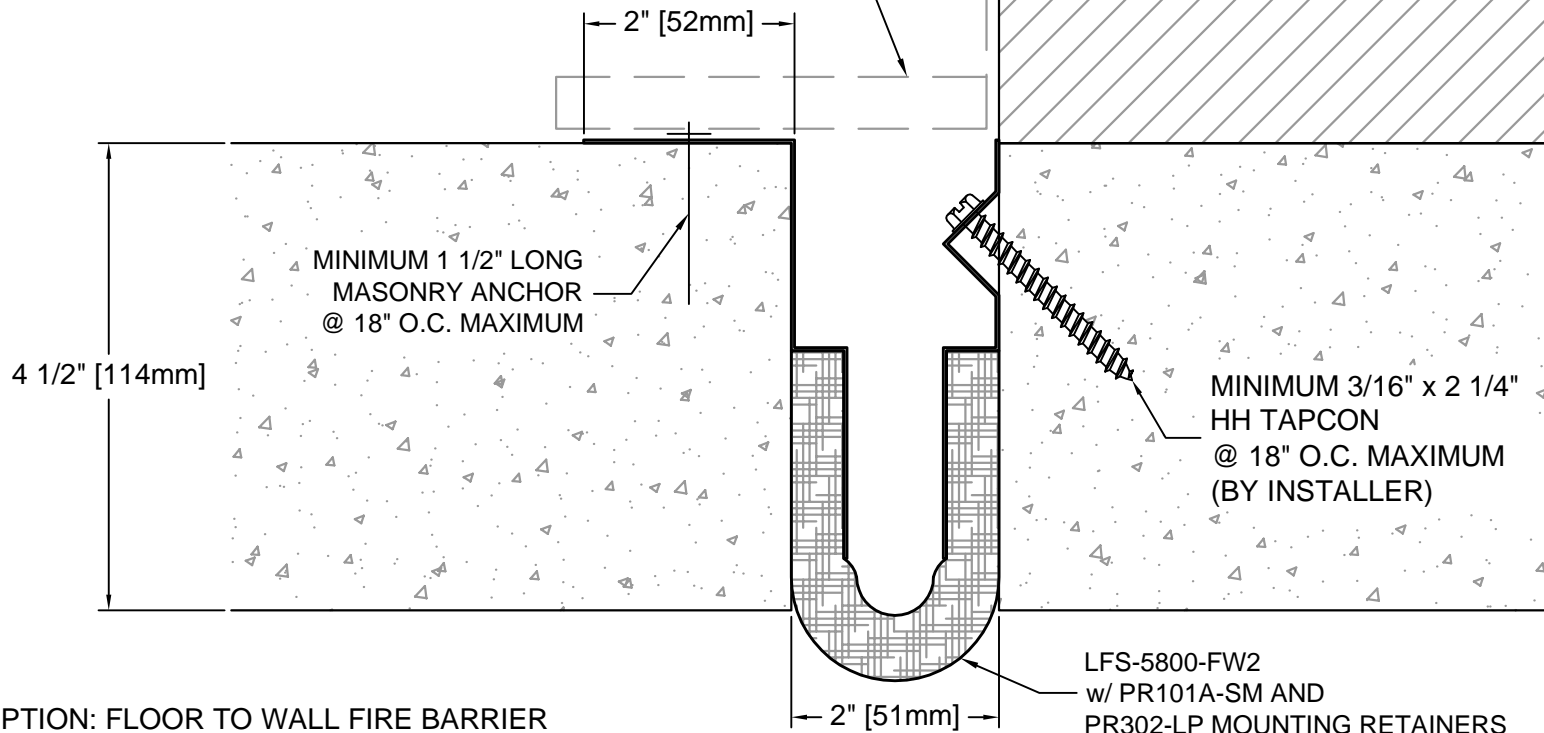

DESCRIPTION: FLOOR TO WALL FIRE BARRIER  
2 HOUR RATED UL ASSEMBLY #FF-D-0043  
NORMAL WEIGHT CONCRETE  
SUITABLE EJ COVER REQUIRED FOR LOAD BEARING APPLICATIONS  
MOVEMENT: ± 50% JOINT WIDTH  
STOCK LENGTHS: FIRE BARRIER 25'-0" ROLLS,  
METAL MOUNTING FLANGES 10'-0"

**P20-FW-02**  
REV. 08/11



**Architectural Art  
MANUFACTURING**

Division of Pittcon Architectural Metals, LLC  
283 SWANSON DRIVE, STE 103  
LAWRENCEVILLE, GA 30043  
PH: (678) 680-7373 FAX: (678) 735-0085  
TOLL FREE: (800) 835-0028 web: www.archart.com

**P Series Floor/Wall Fire Barrier**

MODEL: P20-FW-02 w/PR101A-SM & PR302-LP RETAINERS

DRAWN BY:  
MB

SCALE:  
NTS

DRAWING NO.:

**DTL-01**

ISSUE DATE: 8/18/11

SHT. 1 OF 2

NO.	DESCRIPTION	BY	DATE

REVISIONS

The information contained herein is the proprietary property of **ARCHITECTURAL ART MFG.**, Division of Pittcon Architectural Metals, LLC. No portion of it may be reproduced by any means or used in any form except for the purpose for which it was furnished. All rights of design and invention are hereby reserved. We reserve the right to make changes in the design at our discretion.

DESIGNED TO BE USED WITH  
AN EXPANSION JOINT COVER  
TO CREATE A FIRE RATED ASSEMBLY

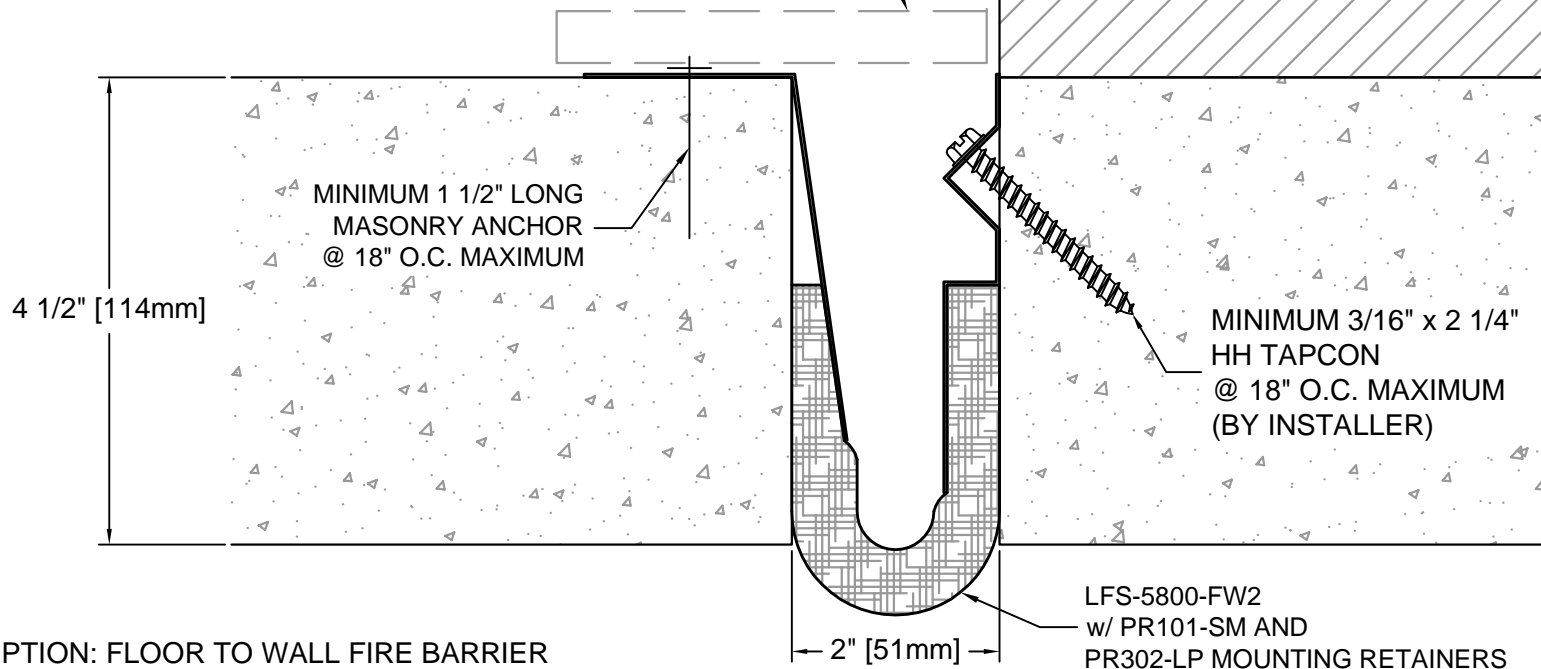

DESCRIPTION: FLOOR TO WALL FIRE BARRIER  
2 HOUR RATED UL ASSEMBLY #FF-D-0043  
NORMAL WEIGHT CONCRETE  
SUITABLE EJ COVER REQUIRED FOR LOAD BEARING APPLICATIONS  
MOVEMENT: ± 50% JOINT WIDTH  
STOCK LENGTHS: FIRE BARRIER 25'-0" ROLLS,  
METAL MOUNTING FLANGES 10'-0"

**P20-FW-02**  
REV. 08/11



**Architectural Art  
MANUFACTURING**

Division of Pittcon Architectural Metals, LLC  
283 SWANSON DRIVE, STE 103  
LAWRENCEVILLE, GA 30043  
PH: (678) 680-7373 FAX: (678) 735-0085  
TOLL FREE: (800) 835-0028 web: www.archart.com

**P Series Floor/Wall Fire Barrier**

MODEL: P20-FW-02 w/PR101-SM & PR302-LP RETAINERS

DRAWN BY: MB	SCALE: NTS	DRAWING NO.:
ISSUE DATE: 8/18/11	SHT. 2 OF 2	<b>DTL-02</b>

NO.	DESCRIPTION	BY	DATE

**REVISIONS**

The information contained herein is the proprietary property of **ARCHITECTURAL ART MFG.**, Division of Pittcon Architectural Metals, LLC. No portion of it may be reproduced by any means or used in any form except for the purpose for which it was furnished. All rights of design and invention are hereby reserved. We reserve the right to make changes in the design at our discretion.