

Architectural Art Mfg.
 Division of Pittcon Architectural Metals, LLC.

**P30 Series FIRE BARRIER
 INSTALLATION INSTRUCTIONS**

Introduction

2 Hour fire barrier for floor and wall applications. See attached instructions for proper installation and splice techniques.

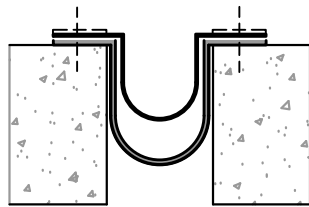

**P30-11-02 TOP
 MOUNT FLOOR**

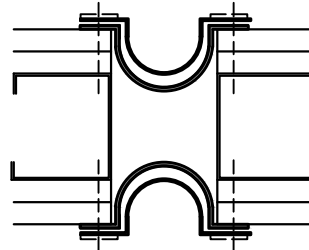

**P30-51-02 DUAL
 SIDE WALL**

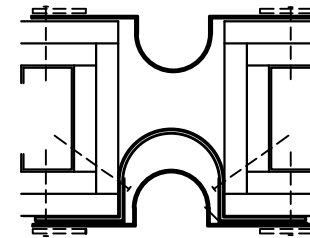

**P30-54-02 SINGLE
 SIDE WALL**



**Architectural Art
 MANUFACTURING**

Division of Pittcon Architectural Metals, LLC
 283 SWANSON DRIVE, STE 103
 LAWRENCEVILLE, GA 30043
 PH: (678) 680-7373 FAX: (678) 735-0085
 TOLL FREE: (800) 835-0028 web: www.archart.com

RIGHTS OF DESIGN

All rights of design, detail, engineering and/or invention contained herein are the property of Architectural Art Mfg. and are not to be reproduced or provided to any other party. Architectural Art Mfg. reserves the right to amend or withdraw any information contained herein without notice and will not be liable for any inaccuracy or ambiguity of said information.

**P30 FIRE BARRIER INSTRUCTIONS
 2 HOUR FLOOR AND WALL**

DRAWN BY: DOC	SCALE: NTS	DRAWING NO.:
SHT. 1 OF 1	ISSUE DATE: 01/07/11	DTL-01

Architectural Art Mfg.
Division of Pittcon Architectural Metals, LLC.

**P30-11-02 FIRE BARRIER
FLOOR INSTALLATION INSTRUCTION**

STEP 1

Remove P30-11-02 FIRE BARRIER from container and unroll along the side of the expansion joint opening with the woven fabric side down.

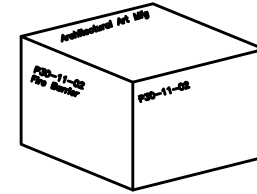

CONTAINER

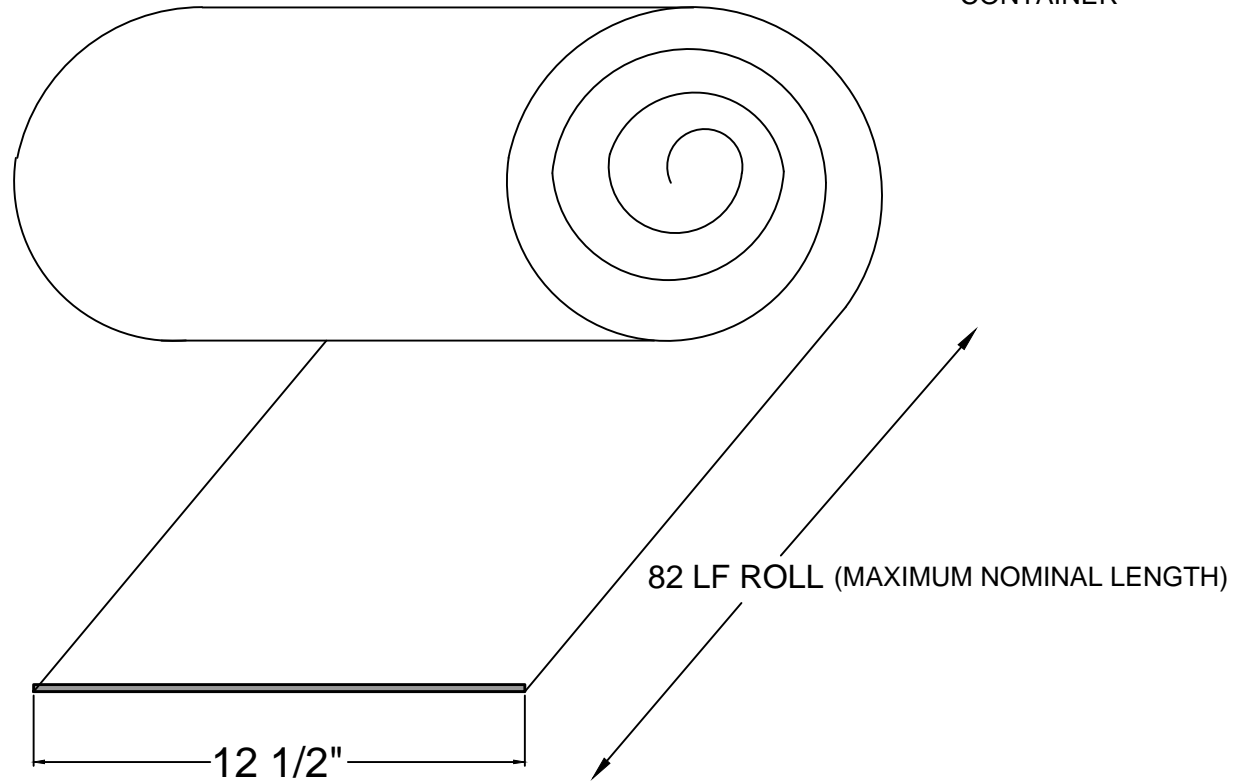

**Architectural Art
MANUFACTURING**

Division of Pittcon Architectural Metals, LLC
283 SWANSON DRIVE, STE 103
LAWRENCEVILLE, GA 30043
PH: (678) 680-7373 FAX: (678) 735-0085
TOLL FREE: (800) 835-0028 web: www.archart.com

RIGHTS OF DESIGN

All rights of design, detail, engineering and/or invention contained herein are the property of Architectural Art Mfg. and are not to be reproduced or provided to any other party. Architectural Art Mfg. reserves the right to amend or withdraw any information contained herein without notice and will not be liable for any inaccuracy or ambiguity of said information.

**P30-11-02
2 HOUR FLOOR FIRE BARRIER**

DRAWN BY: DOC	SCALE: NTS	DRAWING NO.:
SHT. 1 OF 5	ISSUE DATE: 01/07/11	DTL-01

Architectural Art Mfg.
Division of Pittcon Architectural Metals, LLC.

**P30-11-02 FIRE BARRIER
FLOOR INSTALLATION INSTRUCTION**

STEP 2

Cut EPDM MEMBRANE lengthwise into two strips 6" wide minimum.

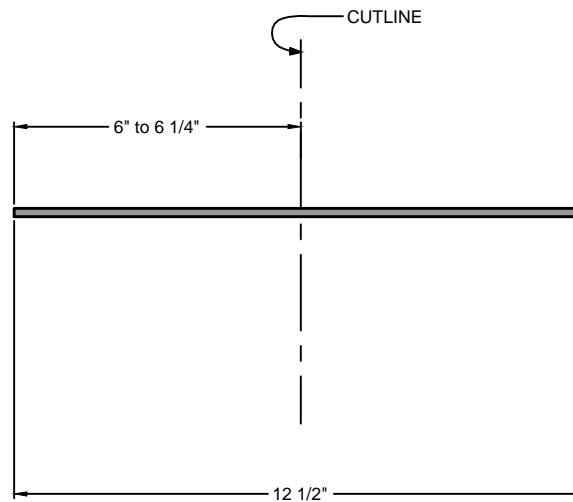

**Architectural Art
MANUFACTURING**

Division of Pittcon Architectural Metals, LLC
283 SWANSON DRIVE, STE 103
LAWRENCEVILLE, GA 30043
PH: (678) 680-7373 FAX: (678) 735-0085
TOLL FREE: (800) 835-0028 web: www.archart.com

RIGHTS OF DESIGN

All rights of design, detail, engineering and/or invention contained herein are the property of Architectural Art Mfg. and are not to be reproduced or provided to any other party. Architectural Art Mfg. reserves the right to amend or withdraw any information contained herein without notice and will not be liable for any inaccuracy or ambiguity of said information.

**P30-11-02
2 HOUR FLOOR FIRE BARRIER**

DRAWN BY: DOC	SCALE: NTS	DRAWING NO.:
SHT. 2 OF 5	ISSUE DATE: 01/07/11	DTL-02

Architectural Art Mfg.
 Division of Pittcon Architectural Metals, LLC.

**P30-11-02 FIRE BARRIER
 FLOOR INSTALLATION INSTRUCTION**

STEP 3

Fold P30 FIRE BARRIER in half without creasing the center. Allow 1 1/2" overlap at joint edges.

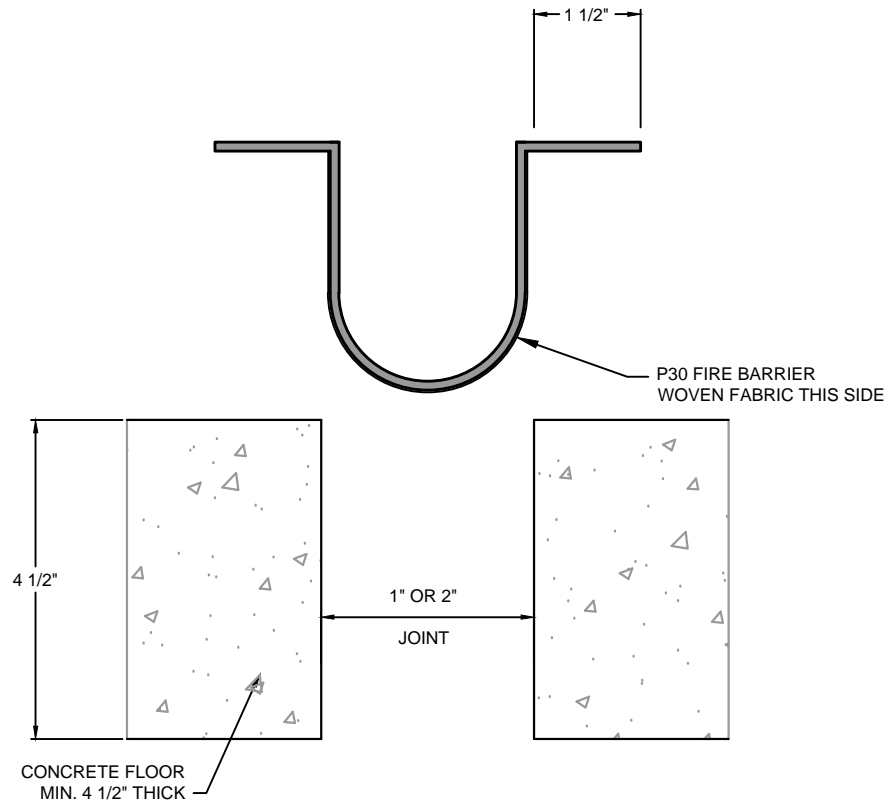

**Architectural Art
 MANUFACTURING**

Division of Pittcon Architectural Metals, LLC
 283 SWANSON DRIVE, STE 103
 LAWRENCEVILLE, GA 30043
 PH: (678) 680-7373 FAX: (678) 735-0085
 TOLL FREE: (800) 835-0028 web: www.archart.com

RIGHTS OF DESIGN

All rights of design, detail, engineering and/or invention contained herein are the property of Architectural Art Mfg. and are not to be reproduced or provided to any other party. Architectural Art Mfg. reserves the right to amend or withdraw any information contained herein without notice and will not be liable for any inaccuracy or ambiguity of said information.

**P30-11-02
 2 HOUR FLOOR FIRE BARRIER**

DRAWN BY: DOC	SCALE: NTS	DRAWING NO.:
SHT. 3 OF 5	ISSUE DATE: 01/07/11	DTL-03

Architectural Art Mfg.
 Division of Pittcon Architectural Metals, LLC.

**P30-11-02 FIRE BARRIER
 FLOOR INSTALLATION INSTRUCTION**

STEP 4

Insert P30 FIRE BARRIER into the joint opening, woven fabric side down. Leave 1 1/2" overlap on the surface of the concrete.

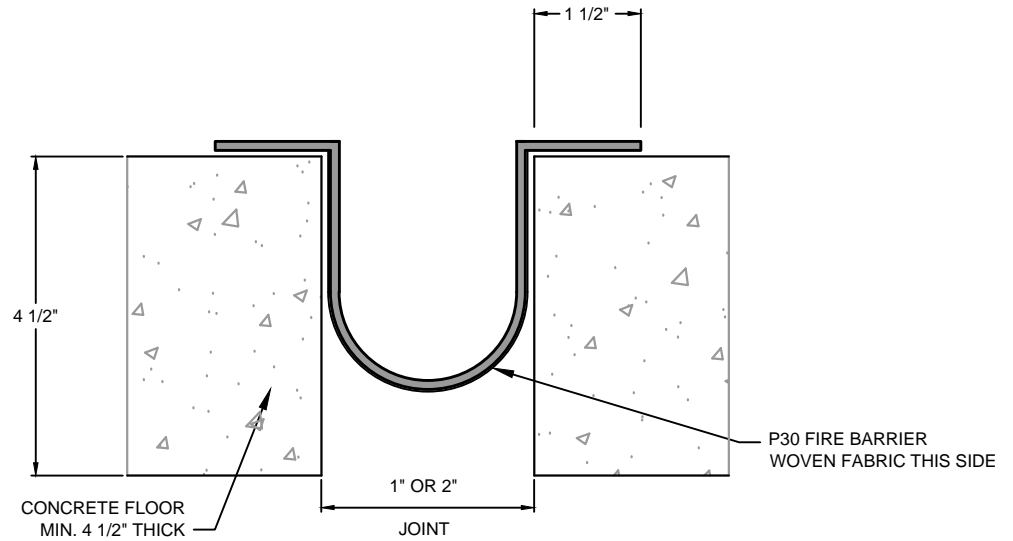

**Architectural Art
 MANUFACTURING**

Division of Pittcon Architectural Metals, LLC
 283 SWANSON DRIVE, STE 103
 LAWRENCEVILLE, GA 30043
 PH: (678) 680-7373 FAX: (678) 735-0085
 TOLL FREE: (800) 835-0028 web: www.archart.com

RIGHTS OF DESIGN

All rights of design, detail, engineering and/or invention contained herein are the property of Architectural Art Mfg. and are not to be reproduced or provided to any other party. Architectural Art Mfg. reserves the right to amend or withdraw any information contained herein without notice and will not be liable for any inaccuracy or ambiguity of said information.

**P30-11-02
 2 HOUR FLOOR FIRE BARRIER**

DRAWN BY: DOC	SCALE: NTS	DRAWING NO.:
SHT. 4 OF 5	ISSUE DATE: 01/07/11	DTL-04

Architectural Art Mfg.
 Division of Pittcon Architectural Metals, LLC.

**P30-11-02 FIRE BARRIER
 FLOOR INSTALLATION INSTRUCTION**

STEP 5

Add 6" wide EPDM to the surface of the P30 FIRE BARRIER and secure with 1/8" X 1 1/2" aluminum bar, 1 1/2" X 20ga galvanized steel strip, or extruded expansion joint cover frame.

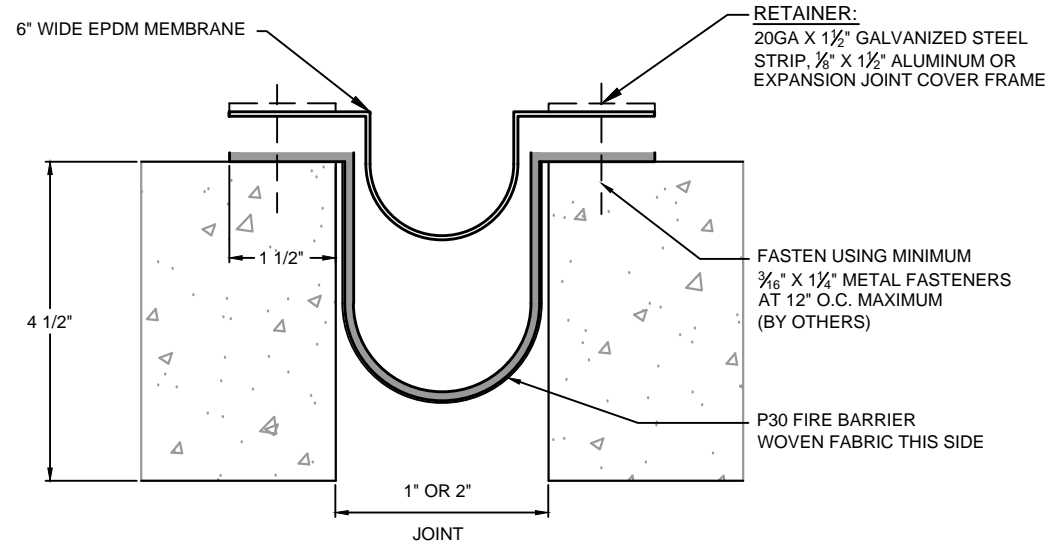

**Architectural Art
 MANUFACTURING**

Division of Pittcon Architectural Metals, LLC
 283 SWANSON DRIVE, STE 103
 LAWRENCEVILLE, GA 30043
 PH: (678) 680-7373 FAX: (678) 735-0085
 TOLL FREE: (800) 835-0028 web: www.archart.com

RIGHTS OF DESIGN

All rights of design, detail, engineering and/or invention contained herein are the property of Architectural Art Mfg. and are not to be reproduced or provided to any other party. Architectural Art Mfg. reserves the right to amend or withdraw any information contained herein without notice and will not be liable for any inaccuracy or ambiguity of said information.

**P30-11-02
 2 HOUR FLOOR FIRE BARRIER**

DRAWN BY: DOC	SCALE: NTS	DRAWING NO.:
SHT. 5 OF 5	ISSUE DATE: 01/07/11	DTL-05

Architectural Art Mfg.
 Division of Pittcon Architectural Metals, LLC.

**P30-51-02 FIRE BARRIER
 WALL INSTALLATION INSTRUCTION
 DUAL SIDE INSTALLATION**

STEP 1

Remove P30-51-02 FIRE BARRIER from container and cut it to length required. Consider all the material needed to make all intersections and transitions per run.

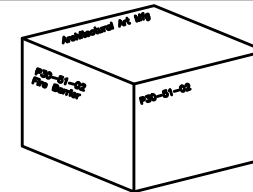

CONTAINER

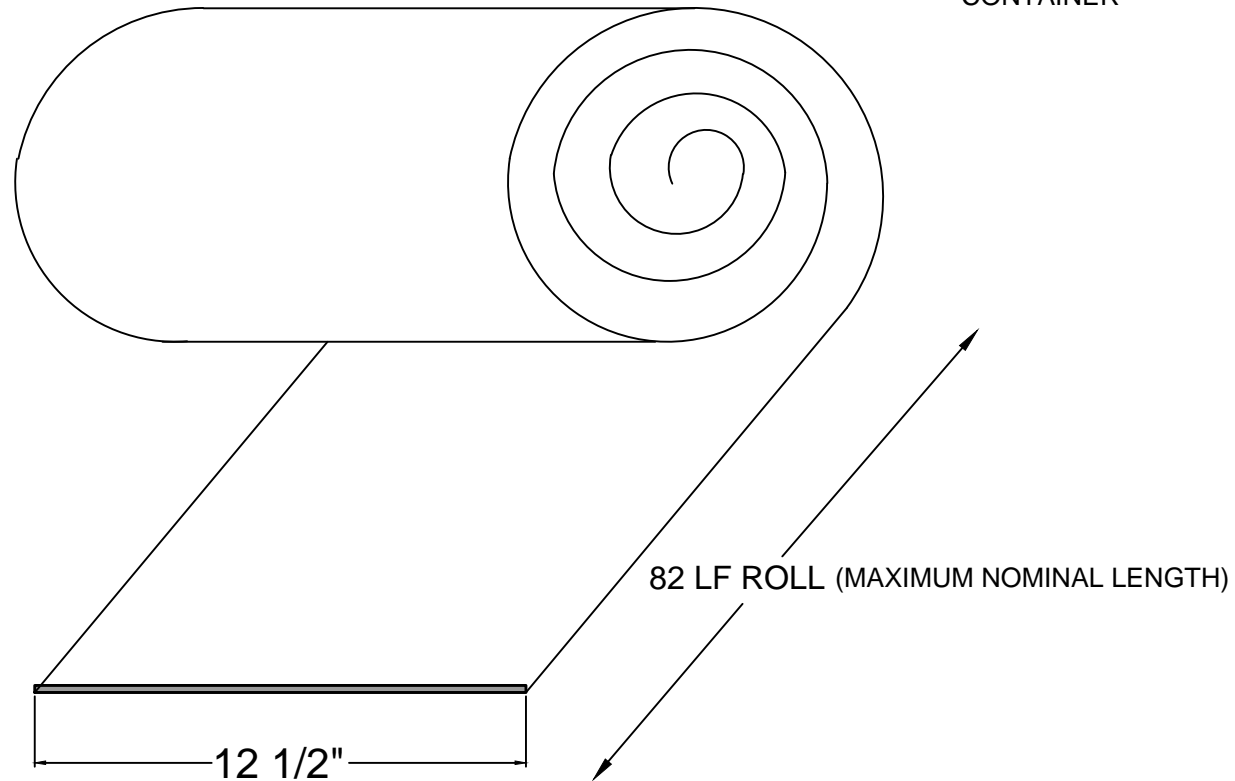

**Architectural Art
 MANUFACTURING**

Division of Pittcon Architectural Metals, LLC
 283 SWANSON DRIVE, STE 103
 LAWRENCEVILLE, GA 30043
 PH: (678) 680-7373 FAX: (678) 735-0085
 TOLL FREE: (800) 835-0028 web: www.archart.com

RIGHTS OF DESIGN

All rights of design, detail, engineering and/or invention contained herein are the property of Architectural Art Mfg. and are not to be reproduced or provided to any other party. Architectural Art Mfg. reserves the right to amend or withdraw any information contained herein without notice and will not be liable for any inaccuracy or ambiguity of said information.

**P30-51-02
 2 HOUR WALL FIRE BARRIER**

DRAWN BY: DOC	SCALE: NTS	DRAWING NO.:
SHT. 1 OF 4	ISSUE DATE: 01/07/11	DTL-01

Architectural Art Mfg.
 Division of Pittcon Architectural Metals, LLC.

STEP 2A

Cut EPDM MEMBRANE lengthwise into two strips 6" wide minimum.

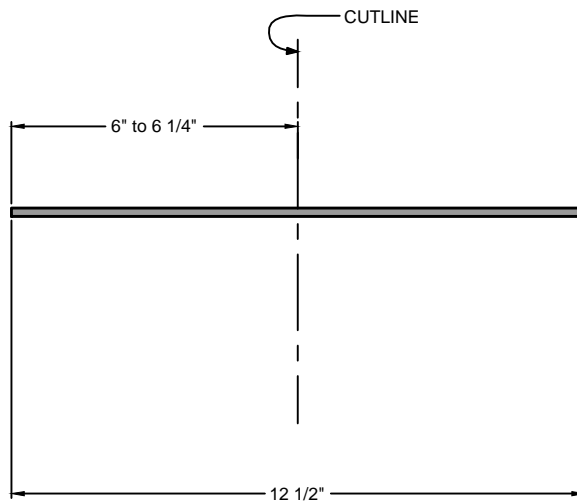

**P30-51-02 FIRE BARRIER
 WALL INSTALLATION INSTRUCTION
 DUAL SIDE INSTALLATION**

STEP 2B

Cut P30 FIRE BARRIER lengthwise into two strips 6" wide minimum.

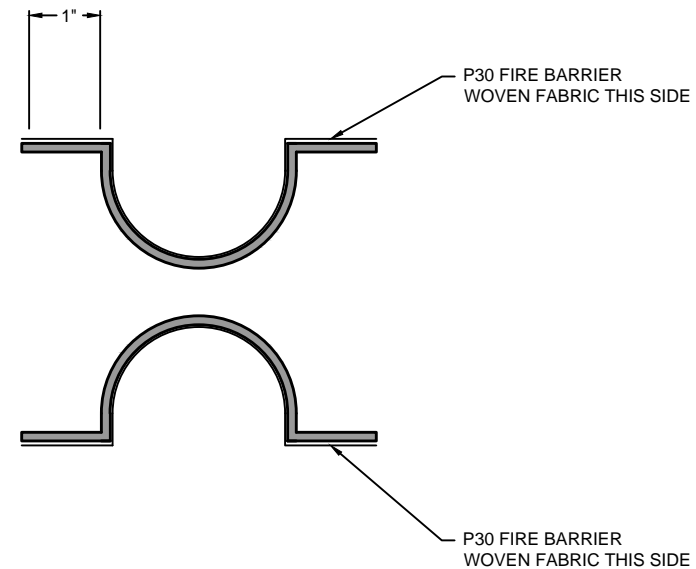

**Architectural Art
 MANUFACTURING**

Division of Pittcon Architectural Metals, LLC
 283 SWANSON DRIVE, STE 103
 LAWRENCEVILLE, GA 30043
 PH: (678) 680-7373 FAX: (678) 735-0085
 TOLL FREE: (800) 835-0028 web: www.archart.com

RIGHTS OF DESIGN

All rights of design, detail, engineering and/or invention contained herein are the property of Architectural Art Mfg. and are not to be reproduced or provided to any other party. Architectural Art Mfg. reserves the right to amend or withdraw any information contained herein without notice and will not be liable for any inaccuracy or ambiguity of said information.

**P30-51-02
 2 HOUR WALL FIRE BARRIER**

DRAWN BY: DOC	SCALE: NTS	DRAWING NO.:
SHT. 2 OF 4	ISSUE DATE: 01/07/11	DTL-02

Architectural Art Mfg.
 Division of Pittcon Architectural Metals, LLC.

**P30 FIRE BARRIER
 SPLICE INSTALLATION INSTRUCTION**

STEP 1

Splice P30 FIRE BARRIER and EPDM 2" overlap.

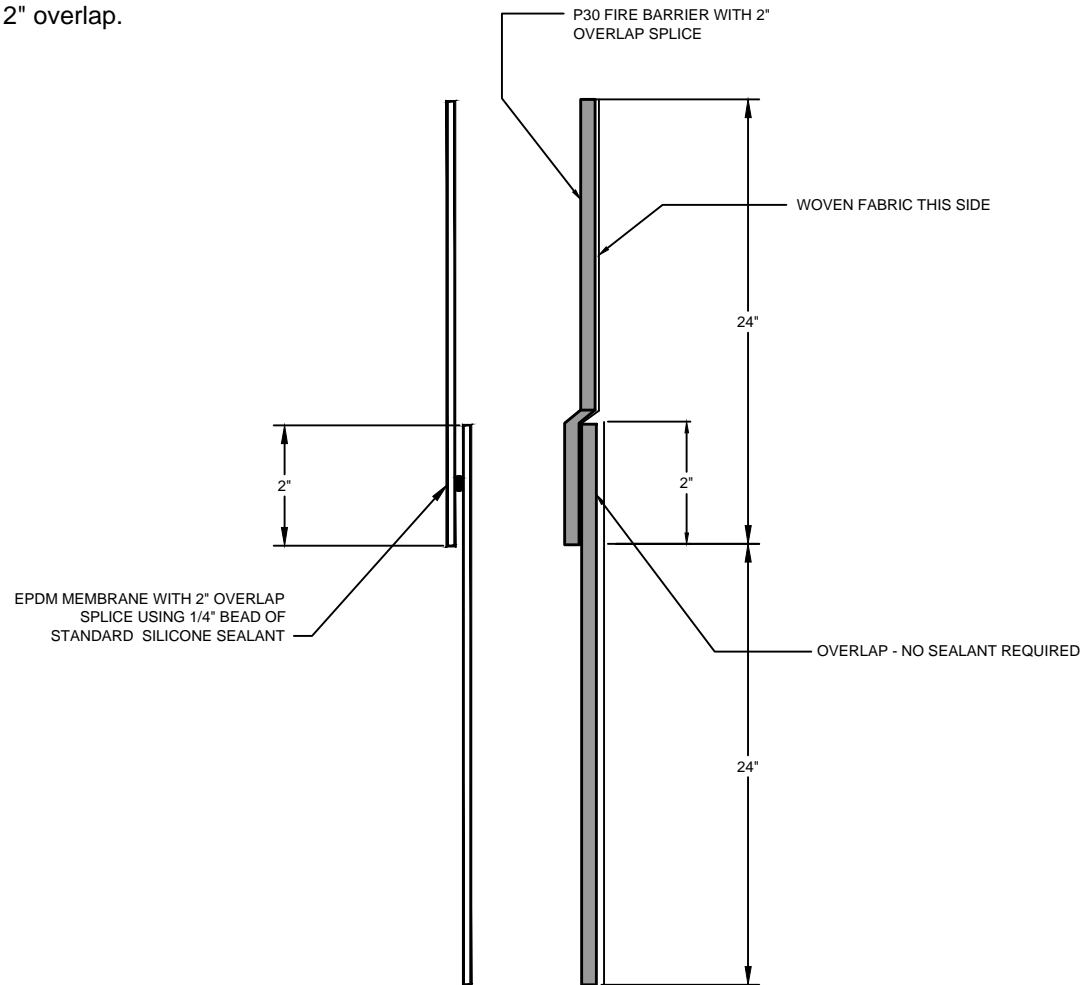

**Architectural Art
 MANUFACTURING**

Division of Pittcon Architectural Metals, LLC
 283 SWANSON DRIVE, STE 103
 LAWRENCEVILLE, GA 30043
 PH: (678) 680-7373 FAX: (678) 735-0085
 TOLL FREE: (800) 835-0028 web: www.archart.com

RIGHTS OF DESIGN

All rights of design, detail, engineering and/or invention contained herein are the property of Architectural Art Mfg. and are not to be reproduced or provided to any other party. Architectural Art Mfg. reserves the right to amend or withdraw any information contained herein without notice and will not be liable for any inaccuracy or ambiguity of said information.

**P30 SPLICE INSTRUCTION
 2 HOUR FLOOR AND WALL**

DRAWN BY: DOC	SCALE: NTS	DRAWING NO.:
SHT. 1 OF 1	ISSUE DATE: 01/07/11	DTL-01

Architectural Art Mfg.
 Division of Pittcon Architectural Metals, LLC.

**P30 Series FIRE BARRIER
 TRANSITION INSTRUCTIONS
 P30-51-02 TO P30-11-02**

Transitions

It is common to encounter conditions where wall and floor fire barriers meet. Transition the wall into the floor fire barrier whenever possible by extending the floor fire barrier beyond the depth of the wall fire barrier where it is recessed into the wall expansion joint cavity. No fire sealant required.

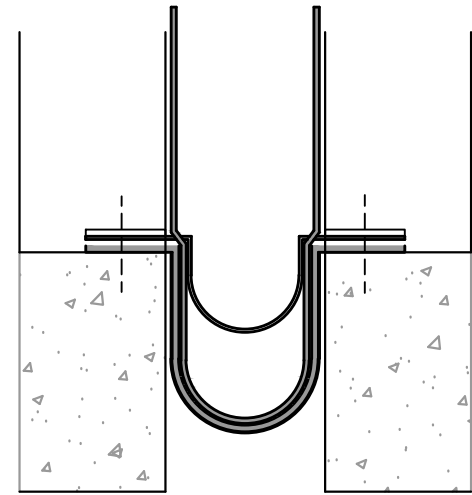
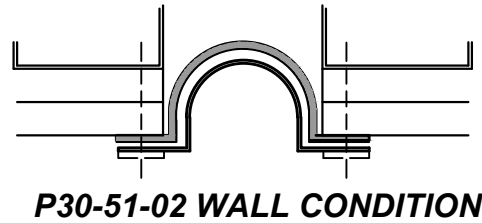
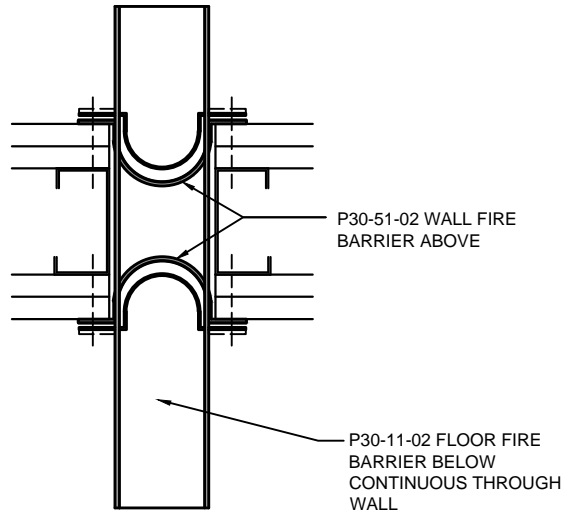

WALL FIRE BARRIER ABOVE

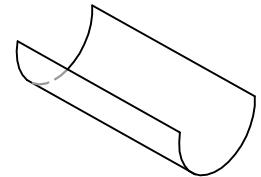
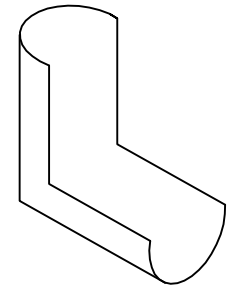

FLOOR FIRE BARRIER BELOW
 (FLANGES NOT SHOWN)

**REPEAT ON BOT
 SIDES OF THE WALL
 VIEW FROM ABOVE**

**P30-11-02 FLOOR CONDITION
 WALL TO FLOOR BELOW TRANSITION**



**Architectural Art
 MANUFACTURING**

Division of Pittcon Architectural Metals, LLC
 283 SWANSON DRIVE, STE 103
 LAWRENCEVILLE, GA 30043
 PH: (678) 680-7373 FAX: (678) 735-0085
 TOLL FREE: (800) 835-0028 web: www.archart.com

RIGHTS OF DESIGN

All rights of design, detail, engineering and/or invention contained herein are the property of Architectural Art Mfg. and are not to be reproduced or provided to any other party. Architectural Art Mfg. reserves the right to amend or withdraw any information contained herein without notice and will not be liable for any inaccuracy or ambiguity of said information.

**P30-51-02 WALL TRANSITION
 INTO P30-11-02 FLOOR BELOW**

DRAWN BY: DOC	SCALE: NTS	DRAWING NO.:
SHT. 1 OF 4	ISSUE DATE: 01/07/11	DTL-01

Architectural Art Mfg.
 Division of Pittcon Architectural Metals, LLC.

**P30 Series FIRE BARRIER
 TRANSITION INSTRUCTIONS
 P30-51-02 TO P30-11-02**

Transitions

It is common to encounter conditions where wall and floor fire barriers meet. Transition the wall into the floor fire barrier whenever possible by extending the floor fire barrier beyond the depth of the wall fire barrier where it is recessed into the wall expansion joint cavity. No fire sealant required.

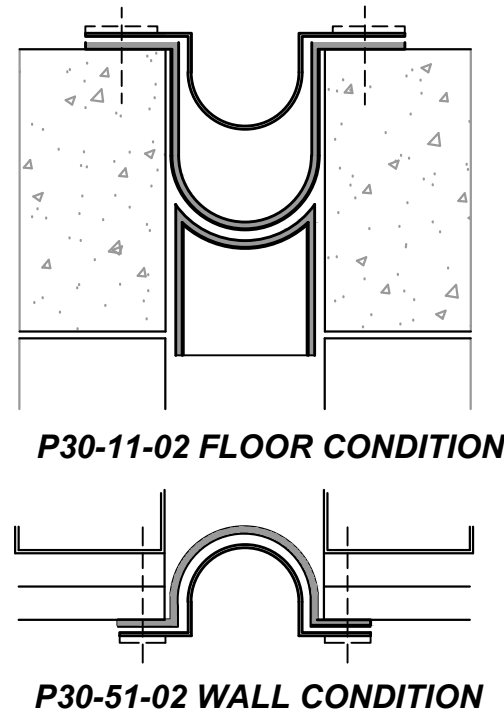
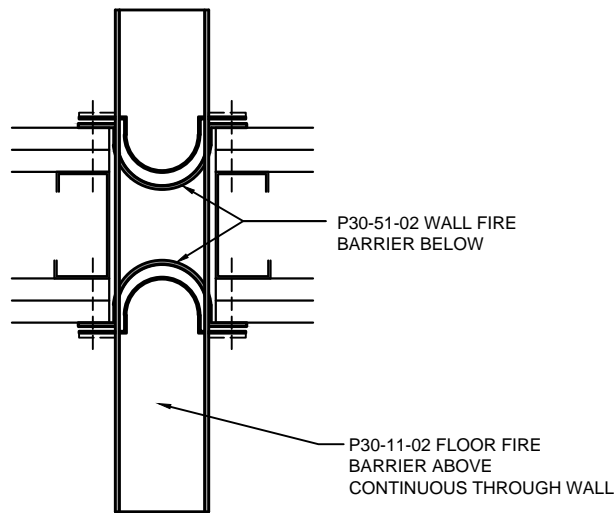

FLOOR FIRE BARRIER ABOVE

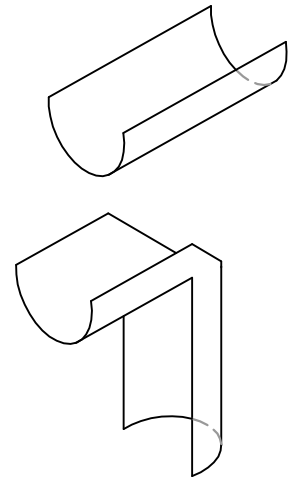

WALL FIRE BARRIER BELOW
 (FLANGES NOT SHOWN)

**REPEAT ON BOTH
 SIDES OF THE WALL
 VIEW FROM BELOW**

WALL TO FLOOR ABOVE TRANSITION



**Architectural Art
 MANUFACTURING**

Division of Pittcon Architectural Metals, LLC
 283 SWANSON DRIVE, STE 103
 LAWRENCEVILLE, GA 30043
 PH: (678) 680-7373 FAX: (678) 735-0085
 TOLL FREE: (800) 835-0028 web: www.archart.com

RIGHTS OF DESIGN

All rights of design, detail, engineering and/or invention contained herein are the property of Architectural Art Mfg. and are not to be reproduced or provided to any other party. Architectural Art Mfg. reserves the right to amend or withdraw any information contained herein without notice and will not be liable for any inaccuracy or ambiguity of said information.

**P30-51-02 WALL TRANSITION
 INTO P30-11-02 FLOOR ABOVE**

DRAWN BY: DOC	SCALE: NTS	DRAWING NO.:
SHT. 2 OF 4	ISSUE DATE: 01/07/11	DTL-02

Architectural Art Mfg.
 Division of Pittcon Architectural Metals, LLC.

**P30 Series FIRE BARRIER
 TRANSITION INSTRUCTIONS
 P30-54-02 TO P30-11-02**

Transitions

It is common to encounter conditions where wall and floor fire barriers meet. Transition the wall into the floor fire barrier whenever possible by extending the floor fire barrier beyond the depth of the wall fire barrier where it is recessed into the wall expansion joint cavity. No fire sealant required.

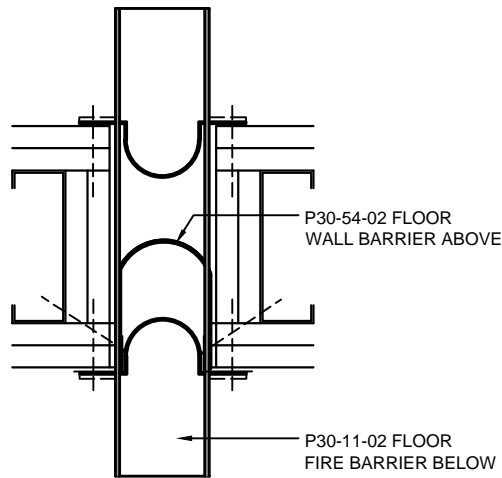

**FLOOR EXTENDS
 BEYOND WALL
 VIEW FROM ABOVE**

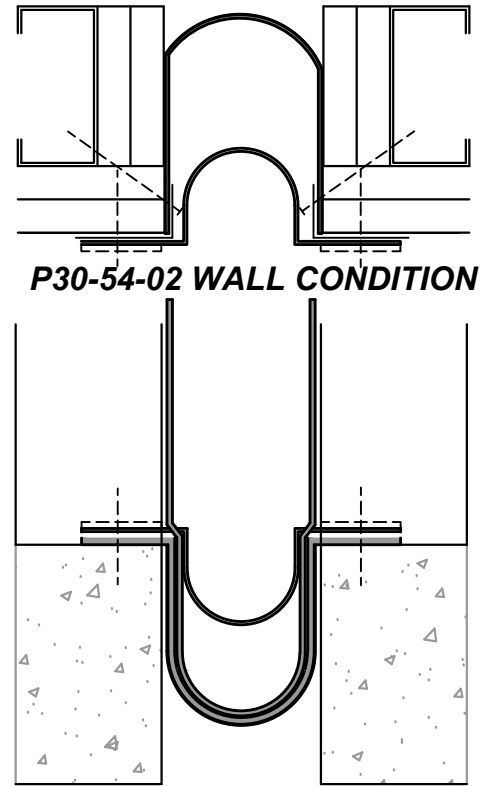

P30-11-02 FLOOR CONDITION

WALL FIRE BARRIER ABOVE

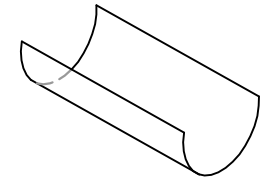
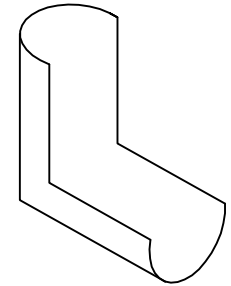

FLOOR FIRE BARRIER BELOW
 (FLANGES NOT SHOWN)

WALL TO FLOOR BELOW TRANSITION



**Architectural Art
 MANUFACTURING**

Division of Pittcon Architectural Metals, LLC
 283 SWANSON DRIVE, STE 103
 LAWRENCEVILLE, GA 30043
 PH: (678) 680-7373 FAX: (678) 735-0085
 TOLL FREE: (800) 835-0028 web: www.archart.com

RIGHTS OF DESIGN

All rights of design, detail, engineering and/or invention contained herein are the property of Architectural Art Mfg. and are not to be reproduced or provided to any other party. Architectural Art Mfg. reserves the right to amend or withdraw any information contained herein without notice and will not be liable for any inaccuracy or ambiguity of said information.

**P30-54-02 WALL TRANSITION
 INTO P30-11-02 FLOOR BELOW**

DRAWN BY: DOC	SCALE: NTS	DRAWING NO.:
SHT. 3 OF 4	ISSUE DATE: 01/07/11	DTL-03

Architectural Art Mfg.
 Division of Pittcon Architectural Metals, LLC.

**P30 Series FIRE BARRIER
 TRANSITION INSTRUCTIONS
 P30-54-02 TO P30-11-02**

Transitions

It is common to encounter conditions where wall and floor fire barriers meet. Transition the wall into the floor fire barrier whenever possible by extending the floor fire barrier beyond the depth of the wall fire barrier where it is recessed into the wall expansion joint cavity.

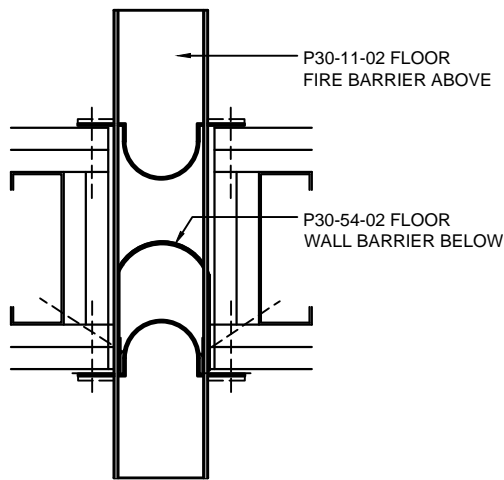

**FLOOR EXTENDS
 BEYOND WALL
 VIEW FROM BELOW**

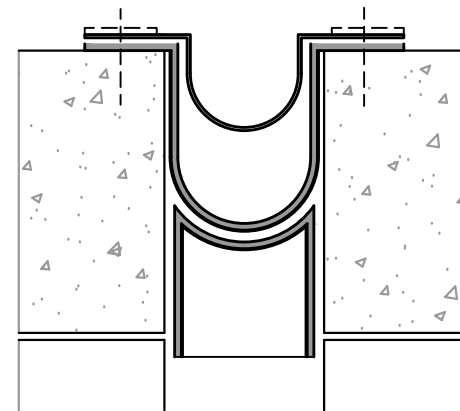

P30-11-02 FLOOR CONDITION

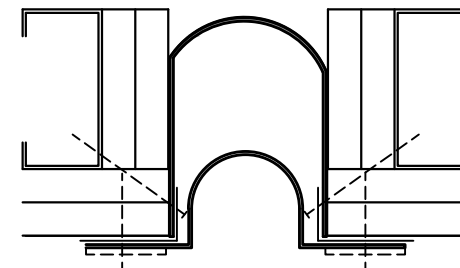

P30-54-02 WALL CONDITION

FLOOR FIRE BARRIER ABOVE

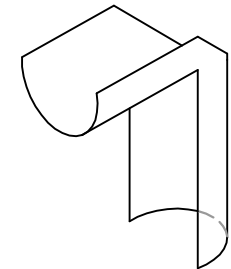
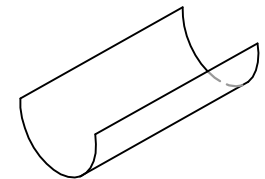

WALL FIRE BARRIER BELOW
 (FLANGES NOT SHOWN)

WALL TO FLOOR ABOVE TRANSITION



**Architectural Art
 MANUFACTURING**

Division of Pittcon Architectural Metals, LLC
 283 SWANSON DRIVE, STE 103
 LAWRENCEVILLE, GA 30043
 PH: (678) 680-7373 FAX: (678) 735-0085
 TOLL FREE: (800) 835-0028 web: www.archart.com

RIGHTS OF DESIGN

All rights of design, detail, engineering and/or invention contained herein are the property of Architectural Art Mfg. and are not to be reproduced or provided to any other party. Architectural Art Mfg. reserves the right to amend or withdraw any information contained herein without notice and will not be liable for any inaccuracy or ambiguity of said information.

**P30-54-02 WALL TRANSITION
 INTO P30-11-02 FLOOR ABOVE**

DRAWN BY: DOC	SCALE: NTS	DRAWING NO.:
SHT. 4 OF 4	ISSUE DATE: 01/07/11	DTL-04

Architectural Art Mfg.
 Division of Pittcon Architectural Metals, LLC.

**P30 Series FIRE BARRIER
 TRANSITION INSTRUCTIONS
 0 CORNER TRANSITION**

Transitions

NOTE: EPDM MEMBRANE is transitioned using the same technique.
 Details show orientation for installing in floor applications. if application is in a ceiling, invert views 180 degrees.

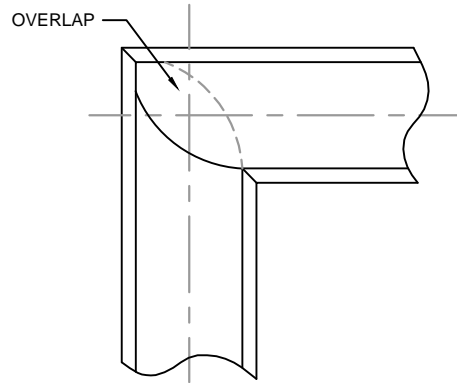

PLAN □IEW

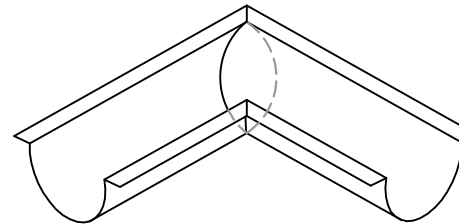

ISOMETRIC □IEW



ELE□ATION



**Architectural Art
 MANUFACTURING**

Division of Pittcon Architectural Metals, LLC
 283 SWANSON DRIVE, STE 103
 LAWRENCEVILLE, GA 30043
 PH: (678) 680-7373 FAX: (678) 735-0085
 TOLL FREE: (800) 835-0028 web: www.archart.com

RIGHTS OF DESIGN

All rights of design, detail, engineering and/or invention contained herein are the property of Architectural Art Mfg. and are not to be reproduced or provided to any other party. Architectural Art Mfg. reserves the right to amend or withdraw any information contained herein without notice and will not be liable for any inaccuracy or ambiguity of said information.

**P30-11-02 FLOOR FIRE BARRIER
 90° CORNER TRANSITION**

DRAWN BY: DOC	SCALE: NTS	DRAWING NO.:
SHT. 1 OF 1	ISSUE DATE: 01/07/11	DTL-01