

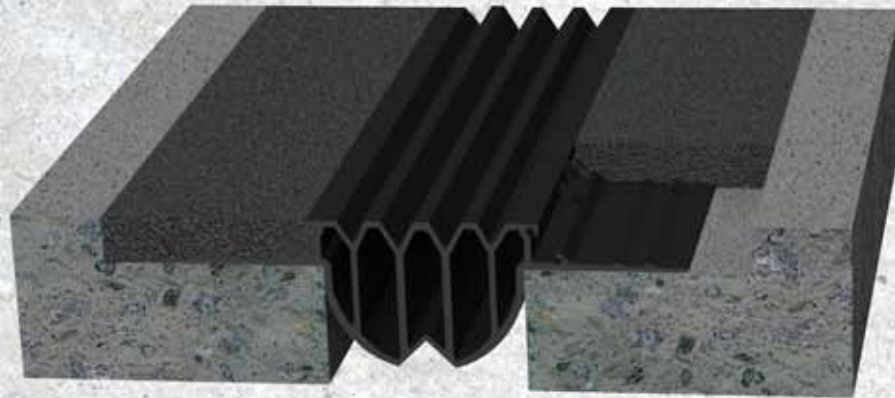

Architectural Art Mfg.

Division of Pittcon Architectural Metals, LLC

Expansion Joint Cover Systems for Parking and Open Air Structures



- **Expansion Joint Covers**

079000 079500 077140 (05810)

Parking Joint Covers

W SERIES



The W Series consist of various designs for waterproof or water resistant conditions for floor and wall expansion joint applications. Typical designs are wing seals, compression seals, epoxy bonded seals, flexible Neoprene designs and metal systems with integrated moisture gutters. Wing seals are attached with our JointCrete™ elastomeric concrete header and other systems are attached with

JointCrete™ epoxy or structural sealants that provide moisture protection at the expansion joint.

Options: Floor to Floor, Floor to Wall, Wall to Wall, Corner Wall. Seal choices in either Neoprene (available in black only) or Santoprene® in Black ■ Beige ■ or Gray ■

Typical applications: Heavy Duty, Open Air Structures, Parking Decks, Arenas, Stadiums, Exterior Conditions. (Fire ratings available)

Wing Seal Floor to Floor

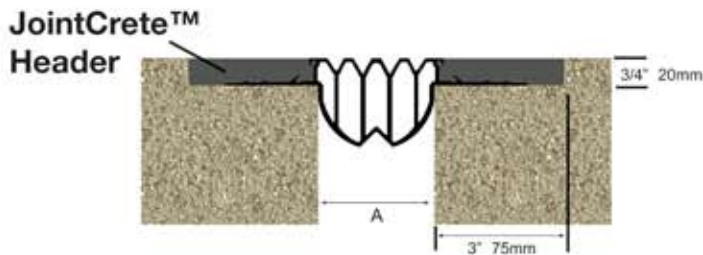

Wing Seal	A	Max Opening	
		mm	A
W20-WS-SA	2	50	2 1/2 63
W30-WS-SA	3	75	4 1/4 106
W40-WS-SA	4	100	5 1/2 138

Wing Seal Floor to Wall

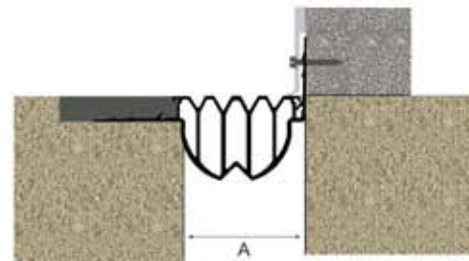

Wing Seal Corner	A	Max Opening	
		mm	A
W20-WSC-SA	2	50	2 1/2 63
W30-WSC-SA	3	75	4 1/4 106
W40-WSC-SA	4	100	5 1/2 138

Epoxy Expansion Seal

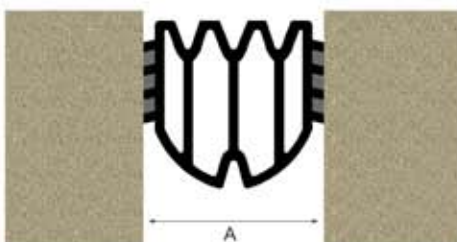

Epoxy Expansion Seal	A	Max Opening	
		mm	A
W20-ES-SA	2	50	2 3/4 71
W30-ES-SA	3	75	4 101
W40-ES-SA	4	100	5 3/8 133

Neoprene Foam Seal

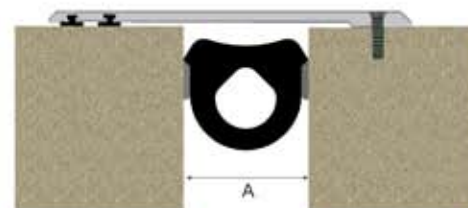

Neoprene Foam Seal	A	Max Opening	
		mm	A
W10-NF-NE	1	25	1 1/2 38
W20-NF-NE	2	50	2 1/4 56
W30-NF-NE	3	75	3 3/4 94

NOTE:
Cover plate required
at traffic conditions
for 2" +

Topping Slab Designs

The Topping Slab System is designed for Plazas, Topping Slabs and other open air structures. Base angles are made of either aluminum or steel and can be supplied in various sizes to accommodate different construction conditions. The mounting plates are made of aluminum with stainless steel traffic guards. The seal is made of Santoprene™ and it is supplied with a self-adhering moisture membrane. The heavy duty block system is made for top deck applications where snow plow traffic is common.

Options: Floor to Floor, Floor to wall, Surface Mount, New to Existing.

Typical Applications: Plazas, Pavers, Topping Slabs, Open Air Structures.
Accommodates joints up to 5 1/2”.

Floor to Floor

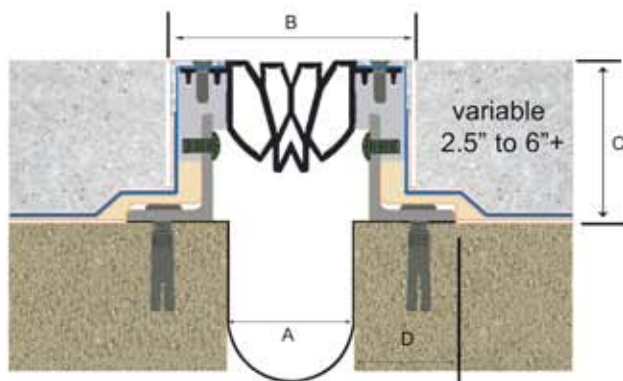

Topping Slab System	A	mm	B	C	D
W20-TS-SA	2	50	5 1/2	138	4 100 2 7/8 72
W30-TS-SA	3	75	5 3/4	144	4 100 2 3/8 59
W40-TS-SA	4	100	6	150	4 100 2 1/8 53

Heavy Duty

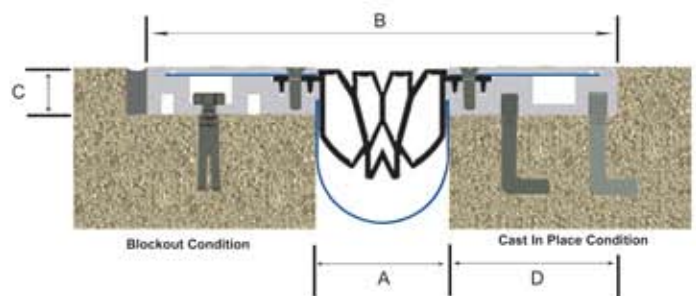

Heavy Duty Block	A	mm	B	C	D
W30-HB-SA	3	75	11	279	1 1/8 30 4 100

Floor to Wall

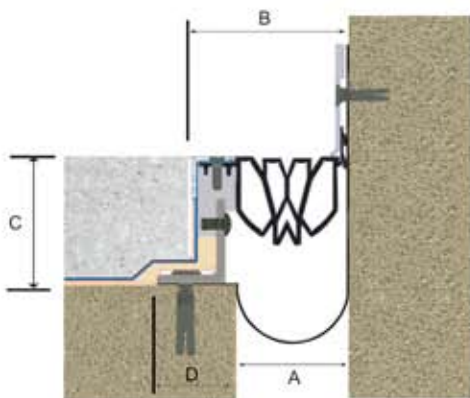

Topping Slab Corner	A	mm	B	C	D
W20-TSC-SA	2	50	3 3/4	94	4 100 2 7/8 72
W30-TSC-SA	3	75	4 3/8	109	4 100 2 3/8 59
W40-TSC-SA	4	100	5	125	4 100 2 1/8 53

Surface Mount

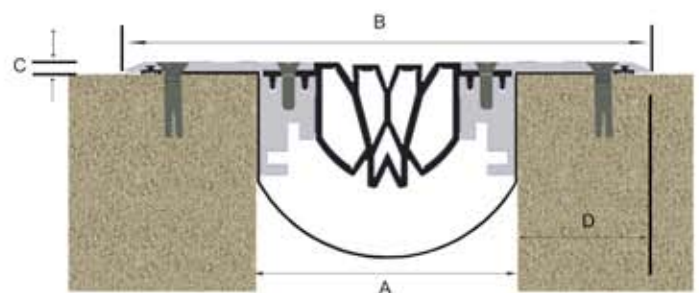

Surface Expansion Seal	A	mm	B	C	D
W50-SE-SA	5	125	10 1/2	267	1/4 6 2 3/4 70

Metal Parking Systems

Metal Parking Systems are made of heavy duty aluminum extrusions and spring-loaded stainless steel hardware for a long life of heavy traffic and adverse weather conditions found in parking decks and open air structures. The Hinged Traffic plate allows for plus or minus 1" deflection under extreme movement conditions and returns to its original position unharmed. All of the Metal Parking Systems come with an integrated gutter and optional drain assembly. The Cast-in systems are designed for post-tensioned construction. The frames can be attached to the forms prior to pouring concrete. Anchors can be situated along the threaded frames to facilitate the post-tension cable construction.

Options: Floor to Floor, Floor to wall, Surface Mount, New to Existing, Blockout mount.

Typical Applications: Used in 4" and larger joints for parking and open air structures requiring heavy duty loads and water tight conditions.

Hinged Surface Plate

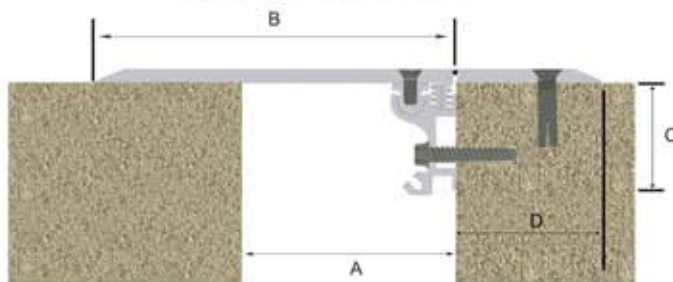

Hinged Surface Plate	A	mm	B	C	D
W40-HS-AL	4	100	7 1/2	3 7/8	4 1/2
W60-HS-AL	6	150	10	3 7/8	4 1/2
W80-HS-AL	8	203	13	3 7/8	4 1/2
W100-HS-AL	10	254	16	3 7/8	4 1/2
W120-HS-AL	12	315	19	3 7/8	4 1/2

Gutter System

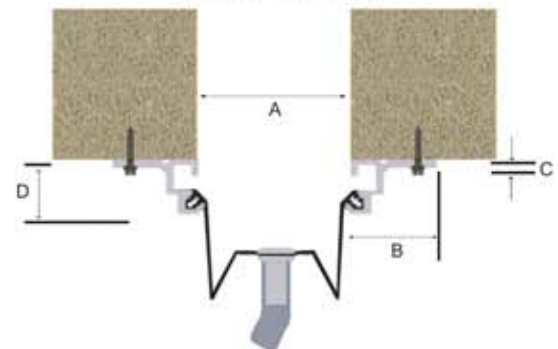

Gutter System	A	mm	B	C	D
W40-GS-SA	4	100	2 1/2	3/16	5 1/2 3
W60-GS-SA	6	150	2 1/2	3/16	5 1/2 3
W80-GS-SA	8	203	2 1/2	3/16	5 1/2 3
W100-GS-SA	10	254	2 1/2	3/16	5 1/2 3
W120-GS-SA	12	305	2 1/2	3/16	5 1/2 3

Also Available in Blockout Applications

Cast In Place

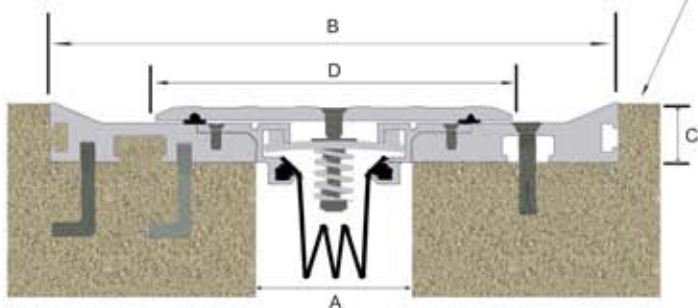

Cast in Aluminum	A	mm	B	C	D
W40-CI-AL	4	100	14 1/2	3 7/8	9 2/3
W60-CI-AL	6	150	16 1/2	3 7/8	12 3/4
W80-CI-AL	8	203	18 1/2	3 7/8	12 3/4
W100-CI-AL	10	254	24 1/2	3 7/8	17 1/2

Cast In Corner

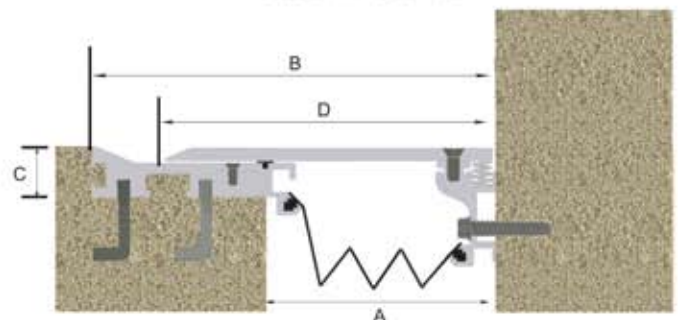

Cast in Corner	A	mm	B	C	D
W40-CIC-AL	4	100	9 1/4	3 7/8	6.5 163
W60-CIC-AL	6	150	11 1/4	3 7/8	9 229
W80-CIC-AL	8	203	13 1/4	3 7/8	10 254
W100-CIC-AL	10	254	16 1/4	3 7/8	13.5 343
W120-CIC-AL	12	305	19 1/4	3 7/8	16 406

Metal Parking Systems

Surfaced Mounted Parking Systems are designed for conditions that were not pre-poured with a block out in the concrete at the expansion joint locations. The aluminum frames are set on a bed of sealant or epoxy that seals the base for water-tightness. The Wing Plate system is designed for optimal water-tightness in a metal parking system. JointCrete™ header can be applied to fill the blockout and create a water tight edge treatment. The integrated gutter found on all metal parking systems is set in silicone sealant when attached to the metal frames sealing out the moisture.

Options: Floor to Floor, Floor to wall, New to Existing, Blockout mount.

Typical Applications: Used in 4" and larger joints for parking and open air structures requiring heavy duty loads and water tight conditions.

Surface Mount

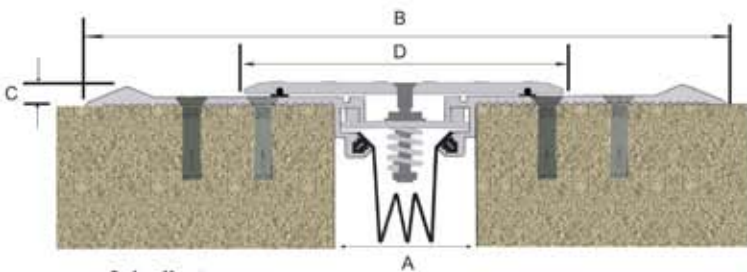

Surface Mount Aluminum	A	mm	B	C	D
W40-SM-AL	4	100	18	457	1/2 13 9 229
W60-SM-AL	6	150	20	505	1/2 13 12 305
W80-SM-AL	8	203	22	559	1/2 13 12 305
W100-SM-AL	10	254	24	610	1/2 13 17 432
W120-SM-AL	12	305	26	660	1/2 13 17 432

Surface Mount Corner

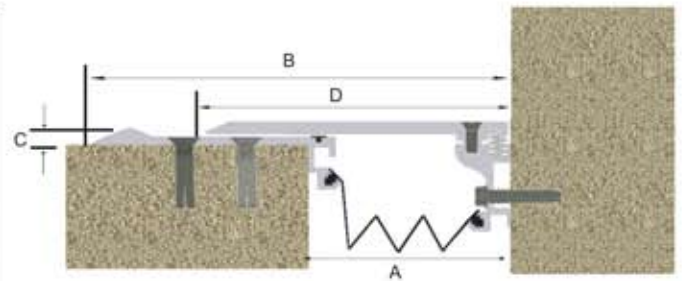

Surface Mount Corner	A	mm	B	C	D
W40-SMC-AL	4	100	9 1/4	235	1/2 13 6.5 163
W60-SMC-AL	6	150	11 1/4	286	1/2 13 9 229
W80-SMC-AL	8	203	13 1/4	336	1/2 13 10 254
W100-SMC-AL	10	254	16 1/4	413	1/2 13 13.5 341

Wing Plate

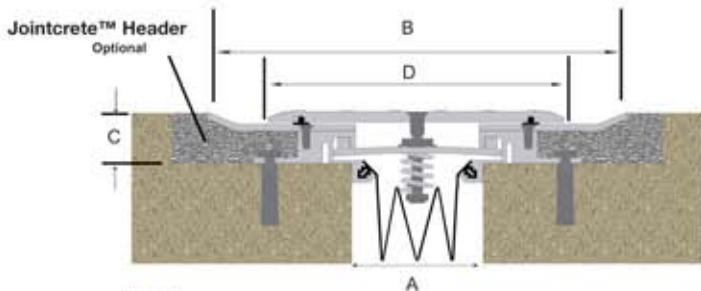

Wing Plate Aluminum	A	mm	B	C	D
W40-WP-AL	4	100	12 3/4	324	1 9/16 39 9 229
W60-WP-AL	6	150	15 3/4	400	1 5/8 41 12 305
W80-WP-AL	8	203	20 3/4	527	1 3/4 44 17 432
W100-WP-AL	10	254	22 3/4	578	1 3/4 44 17 432
W120-WP-AL	12	305	25 3/4	654	1 3/4 44 20 508

Wing Plate Corner

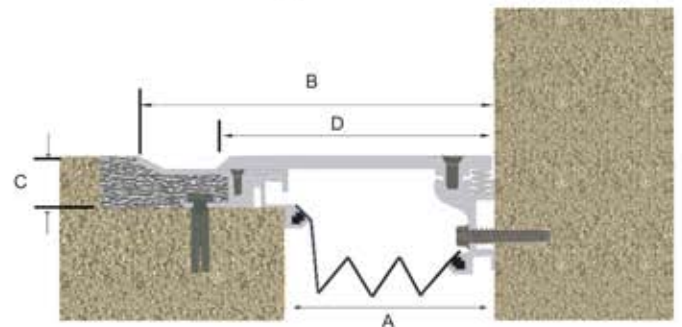

Wing Plate Corner	A	mm	B	C	D
W40-WPC-AL	4	100	9 3/8	238	1 9/16 39 6.5 163
W60-WPC-AL	6	150	11 1/4	286	1 5/8 41 9 229
W80-WPC-AL	8	203	13 1/4	336	1 3/4 44 10 254
W100-WPC-AL	10	254	15 1/4	387	1 3/4 44 23.5 597
W120-WPC-AL	12	305	16 1/4	413	1 3/4 44 16 406

Silicone and Acrylic Foam Systems

Acrylic Foam systems are used for applications requiring watertight, sound reduction and airtight conditions. These systems are simple to install and require no metal fasteners to attach to surrounding construction. The silicone outer layer comes in many different colors to match adjacent construction.

Options: Traffic conditions for floors, walls with acrylic or closed cell neoprene foam backers, secondary seals for below grade and interstitial spaces.

Typical Applications: Exterior walls, floors and areas suitable for compression seals.

Contact factory for
all available foam
seal applications

support@archart.com

Traffic Foam Silicone	A	mm
W10-TF-SI	1	25
W20-TF-SI	2	50
W30-TF-SI	3	75
W40-TF-SI	4	100
W50-TF-SI	5	125
W60-TF-SI	6	150

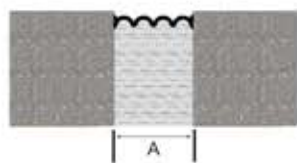

Floor

Silicone Acrylic Seal	A	mm
W10-SA-SI	1	25
W20-SA-SI	2	50
W30-SA-SI	3	75
W40-SA-SI	4	100
W50-SA-SI	5	125
W60-SA-SI	6	150
W70-SA-SI	7	178

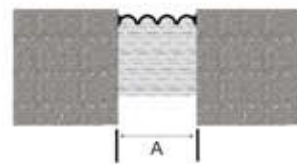

Wall

Silicone Smooth Foam Seal	A	mm
W10-SF-SI	1	25
W20-SF-SI	2	50
W30-SF-SI	3	75
W40-SF-SI	4	100
W50-SF-SI	5	125
W60-SF-SI	6	150
W70-SF-SI	7	178

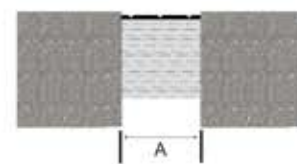

Wall

Secondary Acrylic Foam Seal System	A	mm
W10-AF-NA	1	25
W20-AF-NA	2	50
W30-AF-NA	3	75
W40-AF-NA	4	100
W50-AF-NA	5	125

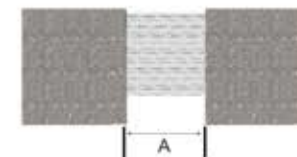

Secondary
Floor
Wall

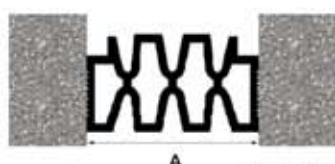

Silicone Wall to Wall	A	mm	A	Max Opening
W10-CS-SI	1	25	2	50
W20-CS-SI	2	50	3 1/2	88
W30-CS-SI	3	75	6	150
W40-CS-SI	4	100	7	178

W SERIES - Silicone

Silicone Color Chart

Black	Limestone	Dusty Rose
Bronze	Precast White	Rustic Brick
Sandstone	Natural Stone	Blue Spruce
Adobe Tan	Gray	Charcoal

Easy To Transition



Easy To Install

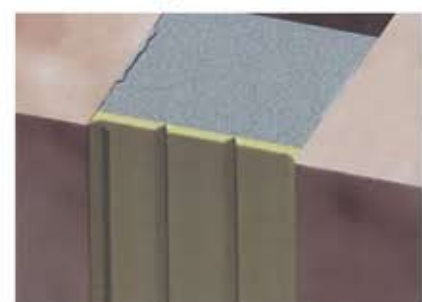

Beautiful
Finish

Architectural Crossover Products

Many of our standard architectural expansion joint cover products are suitable for heavy duty and open air structures. Sometimes a simple cover plate is sufficient material for a particular application. Fire Barriers are available for floor and wall applications for 2 and 3 hour ratings. The A Series glide plate system allows for heavy loads and vertical displacement in 1" and 2" expansion joint openings. All of these systems can be supplied with self adhering moisture membrane or an integrated gutter system. The R Series flexible flat seal comes in 5 standard colors (Black, White, Gray, Beige and Brown) to match adjacent construction and keep the water out of the expansion joint opening.

Reference our Architectural Brochure for our complete line of expansion joint covers and fire barriers.

Options: Floors, Walls, Soffits

Typical Applications: All types of construction for pedestrian and parking applications.

Cover Plate

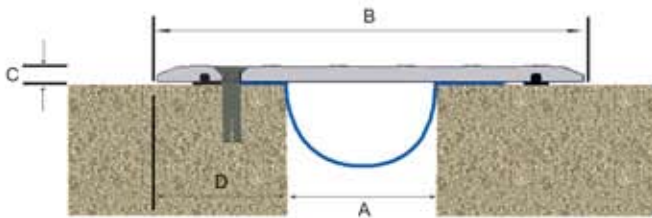

K Series Cover Plate	A	mm	B	C	D
K10-CP-AL	1	25	4 3/16	105	1/4 6 1 1/4 31
K20-CP-AL	2	50	6	150	1/4 6 1 1/4 31
K40-CP-AL	4	100	9	229	5/16 8 2 3/4 69
K60-CP-AL	6	150	12	305	3/8 9 2 3/4 69

Glide Plate

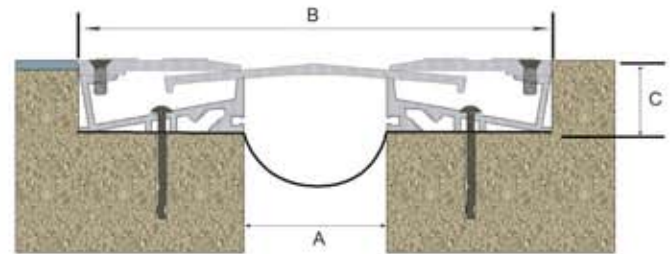

A Series Heavy Duty	A	mm	B	C
A10-HD-AL	1	25	5 5/8	141 1 1/4 31
A15-HD-AL	1 1/2	38	6 1/8	153 1 1/4 31
A20-HD-AL	2	50	6 5/8	166 1 1/4 31
A30-HD-AL	3	75	6 5/8	166 1 1/4 31
A40-HD-AL	4	100	7 1/8	181 1 1/4 31

Exterior Flat Seal

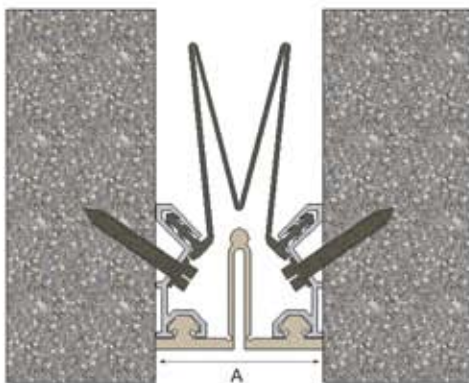

Exterior Wall to Wall System	A
R20-51-91	2
R30-51-91	3
R40-51-91	4
R50-51-91	5
R60-51-91	6

Available up to 24"

Fire Barrier

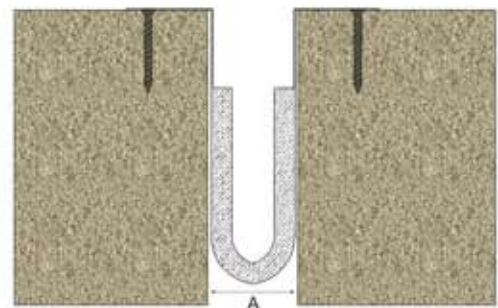

Floor to Floor / Ceiling to Ceiling System	A
P10-12-21	1
P20-12-21	2
P30-12-21	3
P40-12-21	4
P60-12-21	6

Available up to 36"

Floor, Walls 2 & 3 hour ratings



Architectural Art Manufacturing

Division of Pittcon Architectural Metals, LLC

6409 Rhode Island Avenue
Riverdale, MD 20737
(with locations in Arizona, California and Georgia)

Phone: (800) 835-0028
Fax: (316) 462-0511
E-mail: support@archart.com

PITTCON INDUSTRIES can be your single source supplier for all your architectural product needs. All our products are manufactured to the highest industry standards. Architects and Interior Designers specify our products for airports, office buildings, shopping malls, hospitals, schools and many other commercial as well as residential establishments. Our products are designed for easy layout, installation and maintenance.

COLUMN COVERS can give your projects an expensive look at very affordable prices. We offer a variety of types and finishes from which to choose, including glass reinforced gypsum, mirror polished stainless steel, textured metals, laminate clad or painted finishes.

EXPANSION JOINT COVERS are available to suit any situation you may have. Excellent for new and retrofit applications.

DESIGNER DRYWALL is a raised panel gypsum product that can be used to create stylish interiors at a fraction of the cost of traditional raised wood paneling. Available in designs for wall and ceiling applications.

VAULTED CEILING AND LIGHT COVES are available in a number of shapes and sizes. Float a multi-level ceiling using our PERIMETER TRIMS. All come complete with joint connections and hanging attachments.

HAND CRAFTED PATTERN METALS are available in aluminum, stainless steel, brass, and other materials for use in architectural applications. Finishes include your choice of colors in a semitransparent fluoropolymer resin paint for a long lasting and durable finish, suitable for interior or exterior applications.

DRYWALL AND PLASTER TRIMS are in stock and ready to ship. They are available in primed and anodized finishes. Let us help you complete your project on time by supplying you with factory mitered intersections and curved parts.

Locations in:
Maryland, Arizona, California & Georgia
(301) 927-1000 Fax: (800) 897-3129
www.pittconindustries.com
www.archart.com

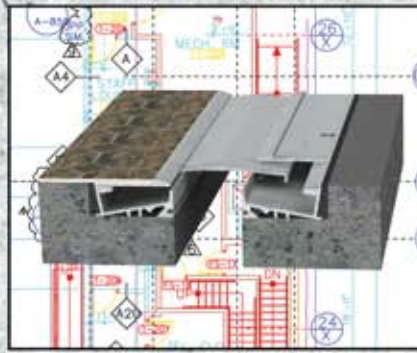

Expansion Joints and Trench Covers



Metal Column Covers



Designer Drywall



GFRG & GFRC Column Covers



Perimeter Trims



Light Coves and Vaulted Ceilings



Hand Crafted Patterns

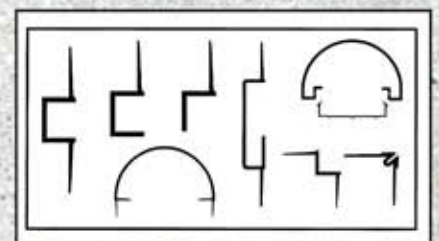

Sofiforms® Drywall Extrusions

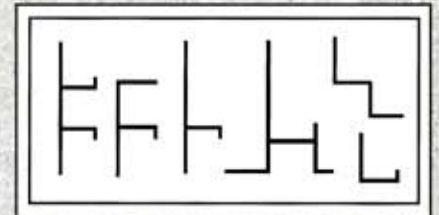

Sofiforms® Plaster Extrusions

Photo credits from front cover:
Gwinnett Braves Stadium:
Architect: HKS
Contractor:
Barton Malow Construction Services
Pala Casino
Architect: Gentile and Harvey
Contractor: Swinerton Builders